

**SIMBA® 2006**  **SAFARI®**



**Live out loud.**

---



> > >

Are you ready to step up to the excitement of a full-size motorhome? Then you're ready for the 2006 Simba. This beauty is big on quality, big on features and, with its seven foot ceiling height, just plain big. You can count on Safari to give you the most versatile floorplans and a wide range of furnishings. Shown here is the convenient booth dinette with an adjustable side-sliding table top, roomy storage drawers and forward-facing seat belts.

SMOKE TREE INTERIOR WITH  
NEW VINTAGE OAK | 37PBD



In the cockpit you'll find everything you need for more comfortable drives, with soft touch vinyl seats and a well-organized automotive dash. And you won't have to look around a center black rubber seam, thanks to our exclusive Panaview™ 1-piece windshield. The coach is also prepped for an optional rear vision system with audio and an adjustable camera.

 **PANAVIEW™**  
1-PIECE WINDSHIELD



On longer trips you'll enjoy the convenience of a large double-door refrigerator. A refrigerator with an ice maker is optional, as are the woven insert panels which match the overhead cabinet doors. The galley features the contemporary styling of a solid surface radius profile countertop, and in the ceiling is an attractive skylight with a pleated shade.



Come & visit us anytime at:  
[SAFARIMOTORCOACHES.COM](http://SAFARIMOTORCOACHES.COM)



*The 2006 Simba is the best value in its class.*

*What a great find!*



SMOKE TREE INTERIOR WITH NEW VINTAGE OAK | 37PBD

> > > Select floorplans feature an impressive bedroom window in the coach's rear cap, providing an open, airy feel — and the spaciousness is further enhanced by the new, deeper 30-inch bed slide-out. The queen bed is flanked by nightstands and has a decorative wood grain headboard. And in the 33PBD and 37PBD floorplans, you have the convenience of a large wardrobe closet with mirrored doors, shown here. For relaxing in style, you'll find a 20" TV (optional on 30PDD) neatly housed in a swing-away cabinet (stationary on the 36DBD).

The Simba's outstanding quality and craftsmanship are reflected in its head-turning exterior. The coach sports new gel coat fiberglass sidewalls, a one-piece peaked fiberglass roof, a rear ladder, and power heated remote exterior mirrors. In addition, the bed-side slide-out housing has been increased to 30" for more living space. Some options include a 3M film front mask and a full-length mud flap (shown here).



Our side-hinged baggage doors are easy to open and give you superior visibility and better access to the luggage and gear you stow below the coach. Pass-through storage bays are perfect for larger items, and the rotocast boxes are a snap to hose down.



*Come & visit us anytime at:*

[SAFARIMOTORCOACHES.COM](http://SAFARIMOTORCOACHES.COM)



## >>> SmartStructure II: Stronger and Better.

The SmartStructure II achieves overall chassis strength by optimizing the inherent benefits of strain-hardened steel in conjunction with an aerodynamic metal removal principle to allow stress flow in the truss system to evenly distribute both static and dynamic loading across the coach platform. Integrity is stamped into the truss system instead of relying on the welds of the tubular structure. This equates to 40% fewer welds and strategically located metal removal to reduce the overall chassis weight and provide for greater carrying capacity. SmartStructure II is fully integrated with your choice of Workhorse or Ford chassis.



Shown here is the Workhorse chassis' Vortec 8100, 8.1L V-8 engine. It features 340 HP and 455 lbs./ft. torque. The Ford chassis comes standard with a 6.8L 3-valve V-10 engine with 362 HP and 457 lbs./ft. torque.

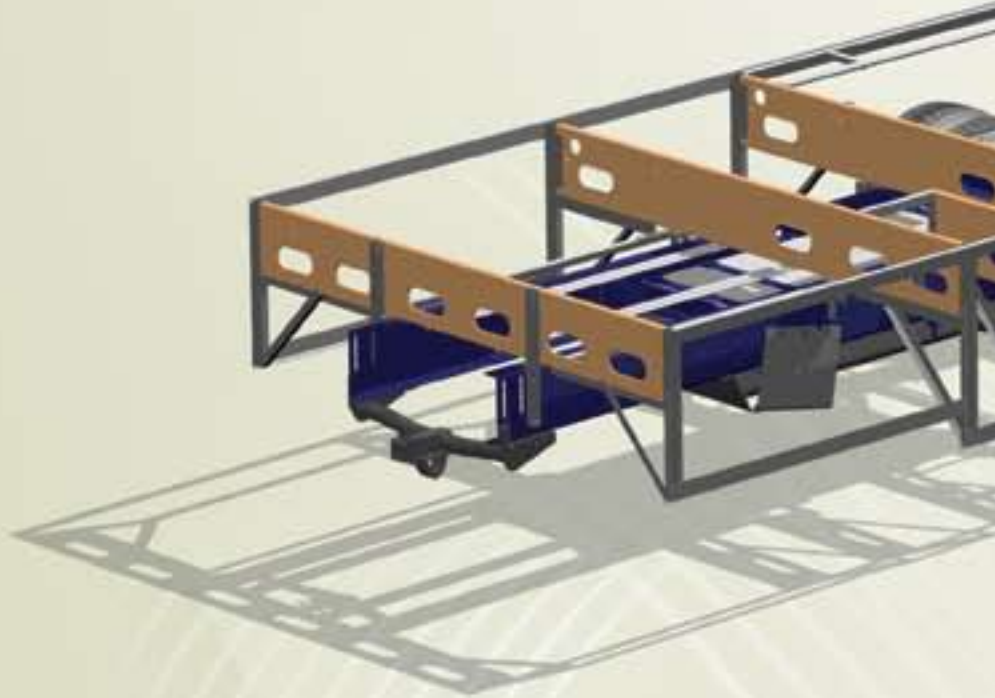

A  
B  
C  
D  
E



### MULTI-LAYER FLOOR:

- A Carpet, pad and laminated tile
- B Structurwood™
- C Blue foam block insulation
- D 1-1/2" aluminum frame
- E 3-layer poly-ply underbelly (New material allows for waterproof bottom on coach and sound resistant/deadening properties)

A B C D E



### 5-LAYER EXTERIOR WALL:

- A Interior paneling
- B 3/4" bead foam adds comfort, saves energy and provides a thermal insulation barrier
- C Vapor barrier
- D Interlocking C-channel filled with 1-1/2" fiberglass insulation bonded in place so it doesn't sag or leave spaces uninsulated
- E High-gloss gel coat fiberglass (33' - 37' floorplans)

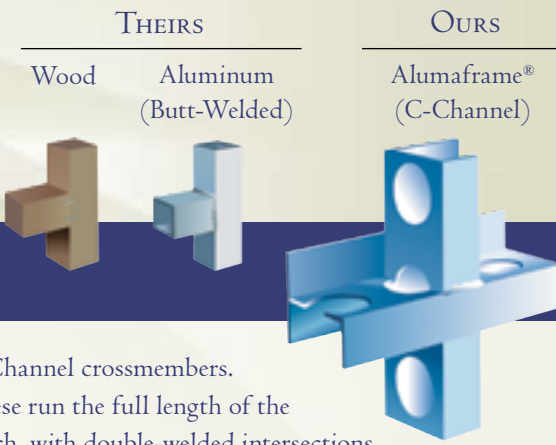
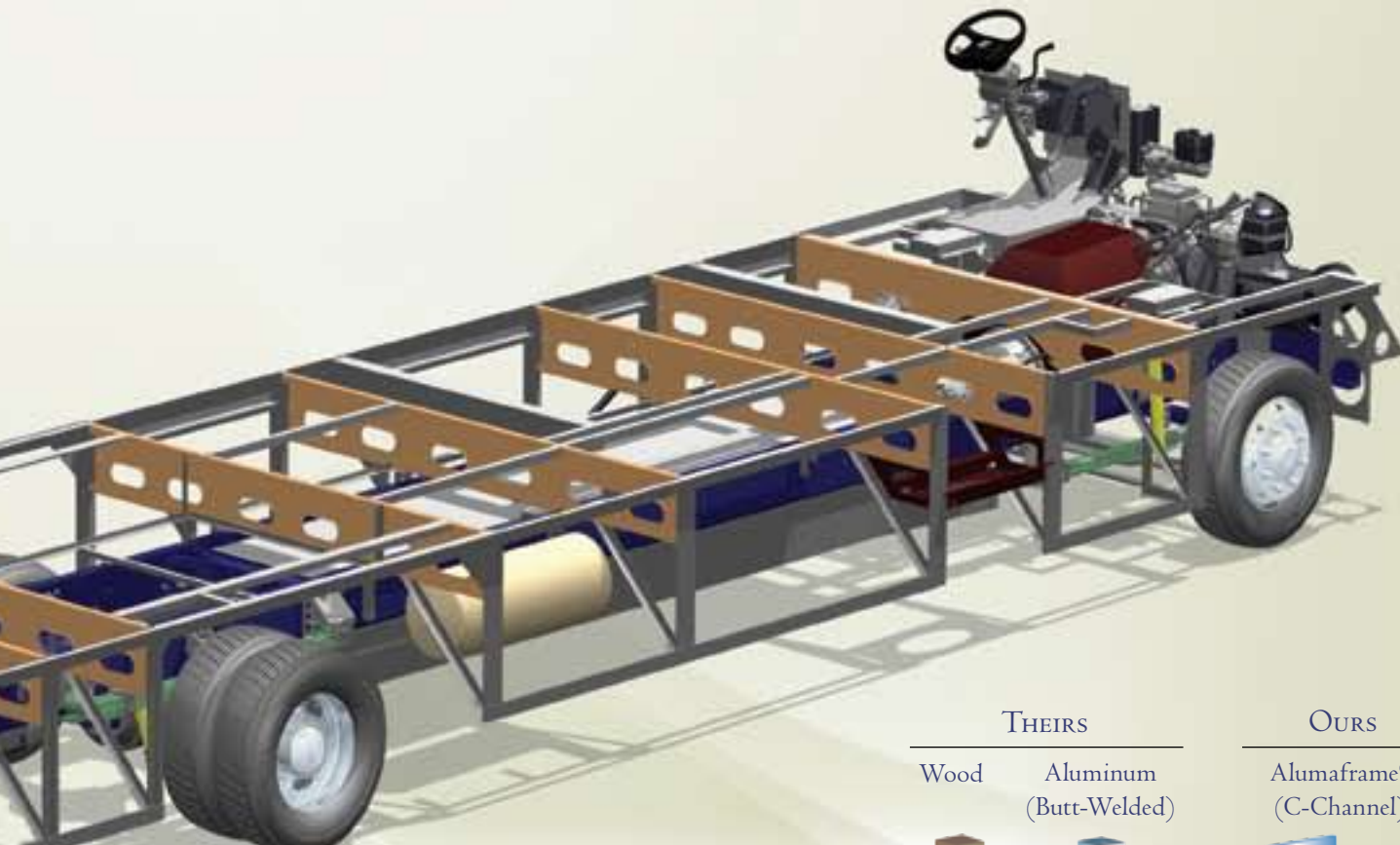

## THE STRENGTH OF ALUMAFRAME®

Thanks to our Alumaframe® Superstructure, your Safari coach is built to take on anything the road can dish out. We revolutionized the industry by replacing outdated wood and tubular aluminum construction with our exclusive system of aluminum

C-Channel crossmembers. These run the full length of the coach, with double-welded intersections for superior strength. This makes your Safari lighter and sturdier than other coaches and gives you reliability you can count on down the road.



### 9-LAYER ROOF CONSTRUCTION:

- A One-piece peaked fiberglass roof
- B Luaun backing
- C Thick, tapered bead foam insulation
- D Fiberglass insulation
- E 3" aluminum double I-beam superstructure
- F Vapor barrier
- G Structure foam: thermal insulative barrier
- H 1/2" bead foam insulation
- I Foam padded vinyl ceiling for extra insulation



*The 2006 Simba*

## ANOTHER STANDARD FEATURE: PEACE OF MIND.

As a Safari owner, you can be sure we're standing behind you. Wherever your travels lead, you can count on us to be only a phone call away. Our staff is available 24/7/365 to help you with virtually any situation that may arise — with troubleshooting, operational instruction or facilitating repairs at the nearest of our 350 nationwide service centers. In addition, you'll be enrolled in our Owner Advantage Roadside Assistance Program free of charge for your first year of ownership — providing additional emergency assistance, including towing, tire repairs and many more services around the clock. In short, when you purchase an RV from Monaco Coach Corporation, you get a wider array of benefits than any other manufacturer can offer. To see it all for yourself, call 1-800-634-0855 or 1-800-650-7337 to arrange a tour of one of our state-of-the-art production facilities in Oregon or Indiana.



New Vintage Oak



Newport Cherry



Champagne Select

### Red Rock



Painted Mask and Skirt Standard



Full-Body Paint Option



Exclusive 30PDD Option



Carpet

Dinette

Sofa

Bedspread



### Rainforest



Painted Mask and Skirt Standard



Full-Body Paint Option



Exclusive 30PDD Option

### Smoke Tree



Painted Mask and Skirt Standard



Full-Body Paint Option



Exclusive 30PDD Option



Carpet



Laminate Tile

33PBD

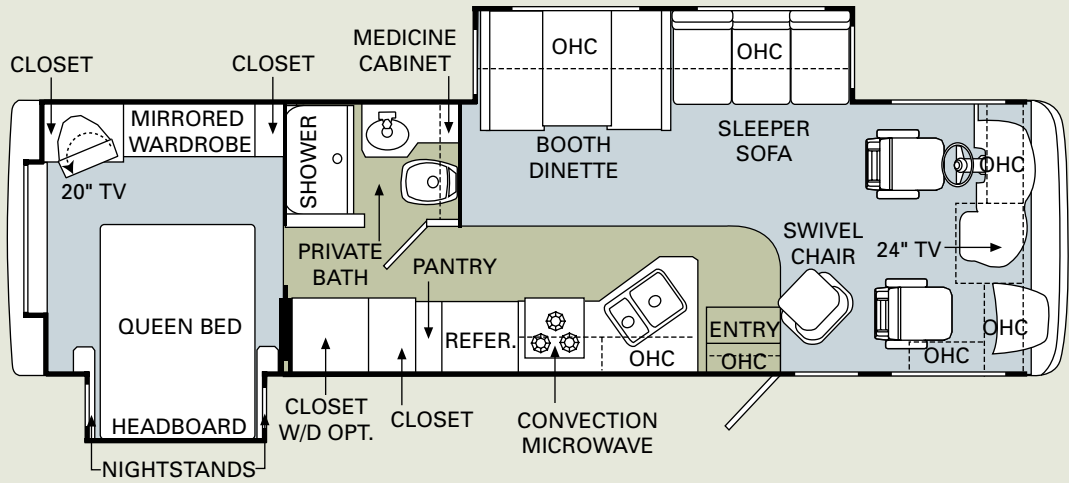

34SBD

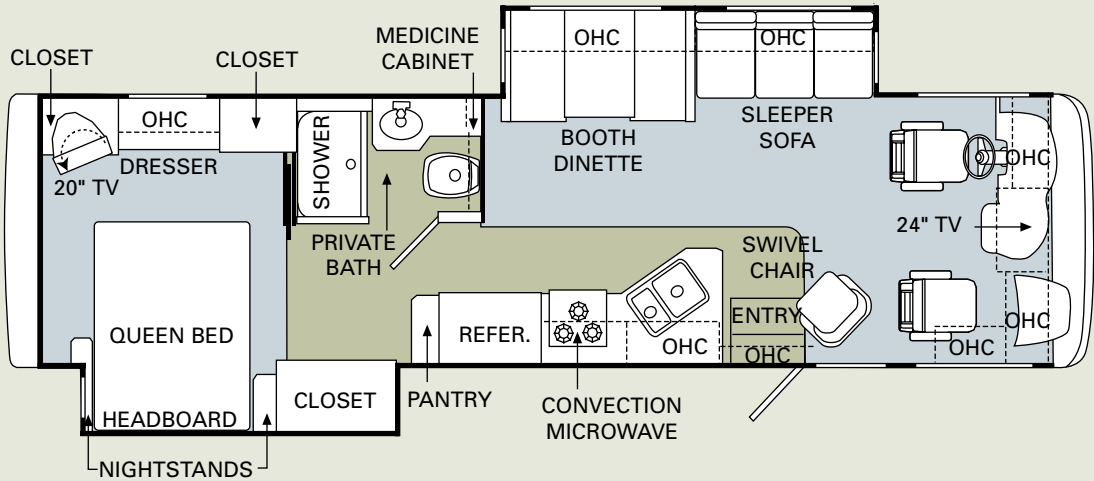

36DBD

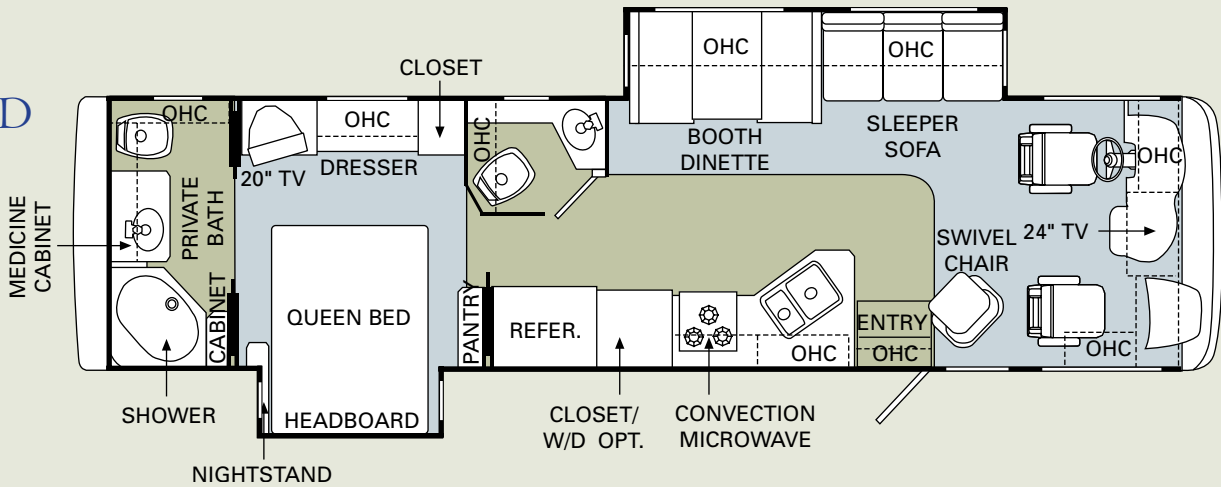

37PBD

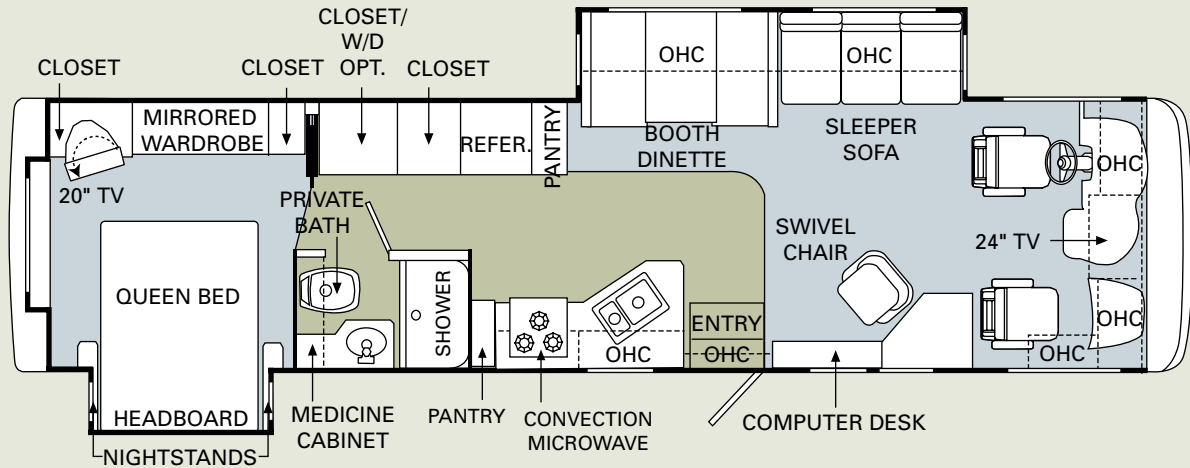

37PCT

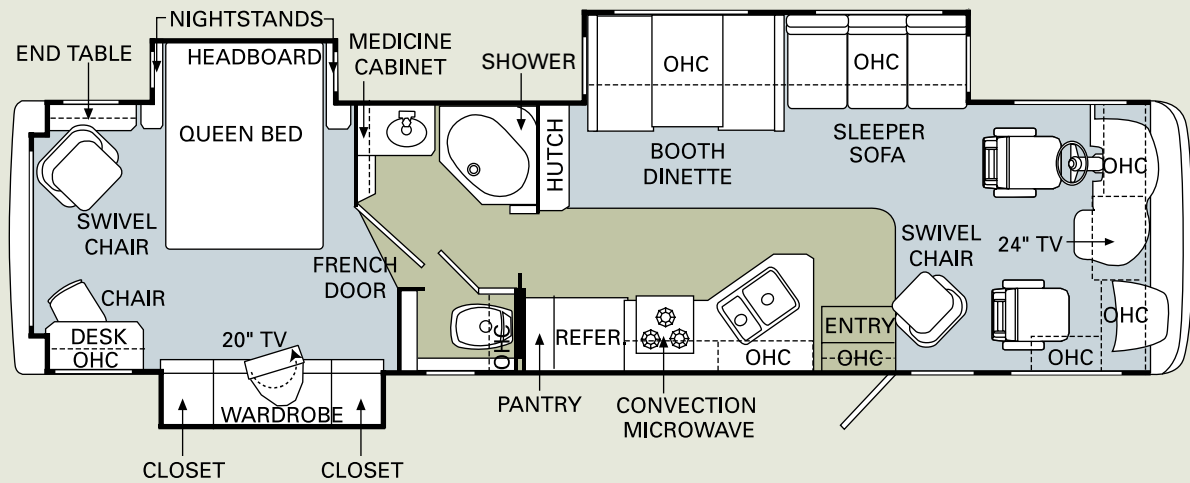

OPTIONS\*

Bedroom Desk (34SBD, 36DBD)

Curbside: New Style Soft Touch Vinyl J-Lounge IPO Swivel Glider Barrel Chair and Computer Desk (37PBD)

Curbside: Two New Style Soft Touch Vinyl Recliners IPO Swivel Glider Barrel Chair and Computer Desk (37PBD)

Fabric Hide-A-Bed Sofa with Two Pillows

Fabric Hide-A-Bed Sofa with Air Mattress and Two Pillows

Fabric Swivel Glider Barrel Chair with Center Lift-Up Table IPO Desk, and Desk Chair Bedroom (37PCT)

Freestanding Round Dinette Table with Two Chairs and Longer Windows IPO Booth Dinette

Soft Touch Vinyl Swivel Recliner Chair IPO Fabric Swivel Glider Barrel Chair

OptimaLeather™ Euro-Recliner Chair with Ottoman IPO Barrel Chair with Center Lift-Up Table

Two Extra Folding Freestanding Dinette Chairs

You can find the 30PDD floorplan on page 16.

\* Optional features will vary by floorplan. See Features & Options.

	33PBD	34SBD	36DBD	37PBD	37PCT
<b>Weights (Ford 20,500 Lb. Chassis) (Lbs.)</b>					
Gross Vehicle Weight Rating	20,500	N/A	N/A	N/A	N/A
Gross Combined Weight Rating*	25,500	N/A	N/A	N/A	N/A
Front Gross Axle Weight Rating	7,000	N/A	N/A	N/A	N/A
Rear Gross Axle Weight Rating	13,500	N/A	N/A	N/A	N/A
<b>Weights (Workhorse 20,700 Lb. Chassis) (Lbs.)</b>					
Gross Vehicle Weight Rating	20,700	N/A	N/A	N/A	N/A
Gross Combined Weight Rating*	25,700	N/A	N/A	N/A	N/A
Front Gross Axle Weight Rating	7,500	N/A	N/A	N/A	N/A
Rear Gross Axle Weight Rating	13,500	N/A	N/A	N/A	N/A
<b>Weights (Ford 22,000 Lb. Chassis) (33PBD Required Option for Ford Chassis) (Lbs.)</b>					
Gross Vehicle Weight Rating	22,000	22,000	22,000	22,000	22,000
Gross Combined Weight Rating*	26,000	26,000	26,000	26,000	26,000
Front Gross Axle Weight Rating	7,500	7,500	7,500	7,500	7,500
Rear Gross Axle Weight Rating	14,500	14,500	14,500	14,500	14,500
<b>Weights (Workhorse 22,000 Lb. Chassis) (Lbs.)</b>					
Gross Vehicle Weight Rating	N/A	22,000	22,000	22,000	22,000
Gross Combined Weight Rating*	N/A	26,000	26,000	26,000	26,000
Front Gross Axle Weight Rating	N/A	8,000	8,000	8,000	8,000
Rear Gross Axle Weight Rating	N/A	14,500	14,500	14,500	14,500
<b>Measurements</b>					
Wheelbase	228"	228"	242"	242"	242"
Overall Length	34' 3"	35' 2"	36' 9"	37' 4"	37' 4"
Overall Height, Including A/C	12' 6"	12' 6"	12' 6"	12' 6"	12' 6"
Interior Height	84"	84"	84"	84"	84"
Interior Width	94.5"	94.5"	94.5"	94.5"	94.5"
Exterior Width	100.5"	100.5"	100.5"	100.5"	100.5"
<b>Tank Capacities** (Gal.)</b>					
Water Heater	10	10	10	10	10
Gray Tank	45	40	45/39	42	45
Black Tank	54	42	45/39	42	54
Fresh Tank	60	60	60	60	60
LP Tank***	24	24	24	24	24

\* Towing capacity is limited by GCWR; your vehicle's towing capacity is the difference between the GCWR and the actual vehicle weight, including all water, fuel, passengers and cargo. Your towed vehicle should be equipped with auxiliary brakes if the weight of the towed vehicle exceeds 1,000 lbs. Consult your Owner's Manual for further towing information.

\*\* All tank capacities are estimated based upon calculations provided by the tank manufacturers and represent approximate capacities. The actual "usable capacity" may be greater or less than the estimated capacities based upon fabrication and installation of the tanks.

\*\*\* Actual filled LP capacity is 80% of listing due to safety shut-off required on tank.

Component part and appliance manufacturers issue limited warranties covering those portions of the recreational vehicle not covered by the limited warranties issued by Monaco Coach Corporation. To learn which specific component parts and appliances are excluded from the limited warranties issued by Monaco Coach Corporation, please contact your selling dealership or Monaco Coach Corporation directly, or review the warranty packet inside the recreational vehicle.

Due to the large variety of options and floorplan arrangements available to our customers, actual weights for each unit can differ significantly. Safari provides a weight sticker on each unit we produce which includes that unit's tank capacities and approximate weight. Consult your local Safari dealer for unit availability and further information. The information printed in this brochure reflects product design, fabrication, and component parts at the date of printing. The manufacturer reserves the right, at any time, to make changes in product design or material or component specifications as its sole option, without notice. This includes the substitution of components of a different brand or trade name, which will result in comparable performance. All information printed in this brochure is subject to change after the date of printing. Some features shown or mentioned in this brochure are optional and may only be available in selected floorplans. Photographs may show props or decorations that are not standard equipment on Safari models. Safari, the Safari logo and its design, are registered trademarks. All other products and company names are trademarks and/or registered trademarks of their respective holders.

While the color of the motorhome's exterior and the interior fabrics depicted in this sales brochure are fair and reasonable depictions, the colors depicted may not be an exact match of the actual colors because of the variances in photo-processing and variances caused by inserting the photographs within the sales brochure. Due to product improvements, changes during the model year and/or transcription errors that may occur, information represented within this brochure may not be accurate at the time of your purchase. If certain information is significant to your purchasing decision, please confirm the information with your dealer prior to submitting your order.

The actual overall length of the recreational vehicle may differ from that indicated in the brochure due to variances in the manufacturing process and/or installed components. The actual length may be greater or less than that indicated.

## Body Construction

- Alumaframe® Superstructure
- Steel Cage Cockpit Construction
- One-Piece Peaked Fiberglass Roof with Fiberglass Insulation
- Smooth Gel Coat Fiberglass Exterior Walls
- Front and Rear Molded Fiberglass Caps
- One-Piece Front Windshield
- Interior Height, 84"
- Aluminum Framed Floor on Steel Trusses
- Laminated Structurwood™ Flooring
- Interior Paneling with 3/4" Insulation
- Foam Insulated Floor Framing with 3-Ply Underbelly
- One-Piece Engine Cover
- Power Heated Remote Exterior Mirrors
- Fog Lights
- Low-Profile Sealed LED Marker Lights
- Chrome Insert around Taillight Area
- Integrated Metal Fuel Door with Lock
- 30" Deep Bedroom Slide-Out Houses
- Pass-Through Storage Bays under Slide-Outs with Roto Cast Boxes
- Side-Hinged Baggage Doors; All Door Locations with Redesigned Extrusion and Latch Locations
- One-Piece Polyethylene Storage Compartment

- Add Exterior Storage above LP Tank
- Painted Mask and Skirt with Vinyl Exterior Graphics
- Rear Ladder
- Interior Rubber Entry Steps with Built-In Stepwell Storage Bucket
- Exterior Triple Entry Steps All Floorplans (Except 33PBD)
- Exterior Double Entry Steps (33PBD)
- Undercoating

### Options

- Deluxe Full-Body Paint with Vinyl Graphics, Any Awning Selected with Full-Body Paint will have Metal Cover
- Chrome Power Heated Remote Exterior Mirrors
- 3M Film Front Mask
- Full-Length Mud Flap
- Standard Run Savings Package: Deluxe Full-Body Paint with Vinyl Graphics, 3M Film Front Mask, Rear Vision System with Audio and Adjustable Camera, Power Sunvisors, Large Four-Door Refrigerator with Ice Maker (N/A with Pantry), Home Theater System with DVD Player with Surround Sound Speakers, Woven Insert Panel Doors on Refrigerator, Energy Management System with 50 Amp Service, 140 Watt Inverter, Storage Compartment Tank Monitor Gauge, Fantastic I2V Attic Fan with Rain Sensor with Electronic Wall Thermostat in Bath, Eclipse Automatic Patio Awning

## Ford Chassis/Engine/Suspension (20,500 Lbs./33PBD) (22,000 Lbs./33'-37' Floorplans)

- 6.8L 3-Valve V-10 Gasoline Engine with Electronic Fuel Injection
- Engine Displacement: 6.8L/415 Cu. In.
- Power: 362 HP
- Torque: 457 lbs./ft.
- TorqShift 5-Speed Automatic Overdrive Transmission with Tow/Haul Mode
- New Transmission Oil Temperature Gauge
- Fuel Tank Capacity 75 Gallon
- I30 Amp Alternator
- Rear Axle Ratio 5.38:1

- Radial Tires (235/80R x 22.5G)
- Wheel/Rims (Polished Aluminum Wheels)
- Leaf Spring Suspension
- Front and Rear Disc, 4-Wheel Anti-Lock Brakes
- Heavy-Duty Front Track Bar with Bilstein® Shock Absorbers
- Fully Automatic Leveling System
- Pre-Wire for Supplemental Braking System
- Hitch Receiver with Dual Connector 4-Pin or 7-Pin (4,000 Lbs.)
- SmartStructure II

## Workhorse Chassis/Engine/Suspension (20,700 Lbs./33PBD) (22,000 Lbs./34'-37' Floorplans)

- 8.1L V-8 Gasoline Engine with Electronic Fuel Injection
- Engine Displacement: 8.1L/496 Cu. In.
- Power: 340 HP
- Torque: 455 lbs./ft.
- 5-Speed Automatic Transmission with Overdrive
- Fuel Tank Capacity 75 Gallon
- I45 Amp Alternator
- Rear Axle Ratio (33PBD - 4.88:1; All Others 5.38:1)
- Radial Tires (33PBD - 245/70R x 19.5F; All Others 235/80R x 22.5G)

- Stainless Steel Wheel Liners
- Leaf Spring Suspension
- ABS Brake System (N/A: 33PBD)
- Fully Automatic Hydraulic Leveling System
- Pre-Wire for Supplemental Braking System
- Hitch Receiver with Dual Connector 4-Pin or 7-Pin (33PBD - 5,000 Lbs.; All Others 4,000 Lbs.)
- SmartStructure II

## Cockpit

- Fiberglass Automotive Dash with Roman Bronze Instrument Panel and Two-Tone Dash Vinyl
- CD Player/Radio with Sirius-Ready Compatibility, Weather Band and Six Speakers
- Multi-Positioned Sunvisors
- Rear Vision System Prep
- Intermittent Windshield Wipers
- Tilt Steering Wheel
- Cruise Control
- Power Steering
- Electric Automotive Horn
- Wood Center Console on Engine Cover, Recess Tray with Rubber Mat and Plastic Two-Tier Cup Holders; Front Tip-Door Ford/Front Drawer Workhorse Chassis
- New Style Soft Touch Vinyl Pilot and Co-Pilot Recliner Seats

- Six-Way Power Pilot Seat
- Carpeted Driver and Passenger Floor Mats
- Dash Workstation
- Wood Framed Cabinet Doors with Smoked Glass over Front Entertainment Center Systems
- Secure Front Cab over TVs with Steel Framing

### Options

- Six-Way Power Pilot Seat
- Rear Vision System with Audio and Adjustable Camera
- 3-Camera Rear Vision System with Audio and Adjustable Center Camera
- Power Sunvisors
- Pilot and Co-Pilot Side Window Pull-Down Sunshades
- CB Radio Prep
- Driver's Side Door with Power Window

## Appliances and Accessories

- Large Double-Door Refrigerator
- High-Output Three-Burner Cooktop without Oven
- Bi-Fold Range Cover
- Spacesaver Convection Microwave with Touch Control
- 24" Flatscreen Stereo Color TV with Remote Control in Cockpit Overhead
- 20" Color TV with Remote Control in Bedroom
- TV Antenna
- DVD Prep and Video Control Box with Booster
- Exterior Hook-Ups for DSS Dish and Cable
- Interior Cable TV Hook-Up and Telephone Jacks
- Digital Satellite System Prep
- Exterior Gas Line Hook-Up Prep for LP Accessories

### Options

- Large Double-Door Refrigerator with Ice Maker
- Large Double-Door Refrigerator with Ice Maker 10 Cu. Ft.
- Large Four-Door Refrigerator with Ice Maker (N/A with Pantry)
- High-Output Three-Burner Range with Oven
- Washer/Dryer Prep, Requires 50 Amp Service Option (N/A: 34SBD, 37PCT)
- Combination Washer/Dryer, Requires Washer/Dryer Prep Option (N/A: 34SBD, 37PCT)
- DVD Player (N/A with Home Theater Option)
- Home Theater System with DVD/VCR Player with Surround Sound Speakers
- Exterior Entertainment Center, CD Player Radio with Two Speakers

## Interior

- New Vintage Oak Cabinetry
- Upper Cabinet Doors with Single Oval Arch with Woven Insert; Flat Panel Doors on Base Cabinets and Wardrobes
- Cabinet End Panels
- Black ABS Refrigerator Insert
- Wallpaper Border Bath
- Self-Supporting Top-Hinged Overhead Storage Doors and Positive Catches on All Other Doors
- Heavy-Duty Ball Bearing Drawer Guides
- Wood Cabinet Drawer Boxes
- Wood Interior Grab Handle on Cabinet at Entry Door
- Long Interior Grab Handle at Entry Door
- Antique Brass Cabinetry Hardware and Bath Accessories
- Integrated Cup Holder to Slide-Out next to Sofa
- Solid Surface Radius Profile Kitchen Countertop, Stainless Steel Sink, Chrome Pullout Faucet and Two Sink Covers
- Toe Kicks Kitchen and Bath Base Cabinets
- Laminate Bathroom Countertop with Decorative Backsplash and Laminate Perm-Edge; All Other Countertops are Laminate with Perm-Edge
- Kitchen Overhead Cabinets with Adjustable Shelf
- Kitchen Pantry next to Refrigerator with Adjustable Shelves in Upper Cabinet and Three Drawers Below (N/A with Four-Door Refrigerator Option)
- Silverware Drawer Organizer Kitchen Base Cabinets (N/A with Range Option)
- Trash Can in Kitchen Base Cabinet
- Mirrors above Kitchen Countertop
- Laminate Tile Flooring in Kitchen and Bath, Kitchen Flooring to Include Entry Door
- Rear Bath Flooring to Match Flooring Selection of Kitchen and Front Bath (36DBD)

- Upgrade Nylon Carpeting with Pad in Living Area and Bedroom
- Soft Touch Padded Vinyl Ceiling
- Wood Slide-Out Fascia with Vinyl Inserts
- Picture next to Dinette Area or Bedroom, Wainscoting Accent under Picture Dinette Area (33PBD, 34SBD, 36DBD, 37PBD, 37PCT in Bedroom)
- Second Picture Hallway Area (34SBD)
- Hutch with Glass Doors/Back Lighted Glass (37PCT)
- Bath Door with Accent Trim on Hallway Side with Woven Inserts
- Wood Trim for Bath Door Opening Hallway Side
- Wood Louvers on Washer and Dryer Doors (N/A: 34SBD, 37PCT)
- French Style Door into Bedroom (37PCT)
- Magazine Rack Bathroom (36DBD, 37PCT)
- Wood Grain Crown Molding in Bedroom and Living Area on All Open Walls
- Bathroom Lavatory Base Mirror with Wood Frame
- Accent Mirror on Rear Wall with Chair Rail and Wainscoting Accent under Mirrors (34SBD)
- Chair Rail and Wainscoting on Rear Wall (33PBD, 37PBD)
- Side Wardrobe Closet with Deluxe Mirror Door Frames Antique Brass Finish (33PBD, 37PBD)
- Bedroom Swing-Away TV Cabinets (Stationary 36DBD)
- Bedspread with Two Decorative Pillows
- Decorative Woodgrain Headboard
- Pleated Day/Night Blackout Shades in Living Area and Bedroom; Mini Blinds in Kitchen and Bathroom Where Applicable
- Soil Repellant on Fabric

### Options

- New Decors: Red Rock, Rainforest, Smoke Tree
- Wood Choice: Newport Cherry, Champagne Select
- Woven Inserts Panel Doors on Refrigerator

## Furniture

- Queen Bed with Nightstands
- Arched Back Wood Booth Dinette with Side-Sliding Table Top and 30" Drawer
- Forward-Facing Seat Belts in Booth Dinette inside Living Area Slide-Out
- New Style Fabric Wall Hugger Sleeper Sofa, Two Pillows on All Sofas
- New Style Fabric Swivel Glider Barrel Chair
- Fabric Swivel Glider Barrel Chair and Desk Chair Bedroom (37PCT)

### Options

- New Style Fabric Hide-A-Bed Sofa with Two Pillows
- New Style Fabric Hide-A-Bed Sofa with Air Mattress and Two Pillows
- Curbside: Soft Touch Vinyl J-Lounge IPO Swivel Glider Barrel Chair and Computer Desk (37PBD)

### Options continued

- New Style Soft Touch Vinyl Swivel Recliner Chair IPO Fabric Swivel Glider Barrel
- OptimaLeather™ Euro-Recliner Chair with Ottoman IPO Barrel Chair with Center Lift-Up Table
- Fabric Swivel Glider Barrel Chair with Center Lift-Up Table IPO Desk, and Desk Chair in Bedroom (37PCT)
- Curbside: Two New Style Soft Touch Vinyl Recliners IPO Swivel Glider Barrel Chair and Computer Desk (37PBD)
- Bedroom Desk (34SBD, 36DBD)
- Freestanding Round Dinette Table with Two Chairs and Longer Windows IPO Booth Dinette
- Two Extra Folding Freestanding Dinette Chairs

## Electrical Systems and Lights

- 30 Amp 120V Distribution Panel and Power Cord
- 60 Amp Electronic 12V Power Converter
- Onan® 5.5 kW Gas Generator
- Two 6V House Batteries
- Battery Disconnect Switches
- 12V and 110V Outlet in Cockpit Area
- Porch Light and Exterior Step Light on Same Switch
- Exterior Power Entry Step with Light
- Interior Stepwell Entry Step Lights
- Water Pump Switch in Service Bay Area and Convenience Center
- Lights in Outside Storage Compartments
- 120V Receptacles in Outside Storage Compartment
- Underhood Utility Light
- Receptacle and Phone Jack in Dinette Area
- Directional Map Lights Pilot and Co-Pilot Seats
- Redesigned Convenience Center in Hallway
- Fluorescent Light(s) with Night Light Function, under Kitchen Overhead

- Fluorescent Ceiling Lights Throughout
- Fluorescent Ceiling Lights inside Living Area inside Slide-Out House
- Decorative Wood Framed Galley Ceiling Fluorescent Light with Skylight and Shade
- Decorative Antique Brass Finish Lighting Living Room Wall Light, Dinette Overhead, Cosmetic Vanity Light
- Halogen Lights under Living Room and Dining Room Overhead Cabinets
- Reading Lights over Bed, Black Finish with His and Hers Switches on Each Side above Nightstands
- Wardrobe Closet Lights (N/A: 33PBD, 37PBD)

### Options

- Energy Management System with 50 Amp Service
- 50 Amp 120V Distribution Panel and Cord
- 140 Watt Inverter
- Storage Compartment Tank Monitor Gauge

## Plumbing and LP Systems

- Kitchen Stainless Steel Sink with Single Lever Chrome Pullout Faucet
- Separate Chrome Faucet for Filtered Water
- Bath Lavatory Faucet Single Handle Antique Brass Finish
- Demand Water System and Water Pump
- 10 Gallon LP Gas/Electric Water Heater with Electronic Ignition, DSI
- Winterization Valving System
- Water Heater Bypass Valve
- Toilet with Sprayer
- No-Fuss Flush Holding Tank Rinsing System
- Insulated Systems Compartment with Easy Access to Hook-Up
- New Style Shower inside Wet Bay with Hot/Cold Water
- Soap Dispenser inside Utility Bay

- Gravity and Pressurized Water Fill
- Contained Storage Area for Sewer Hose
- One-Piece Fiberglass Shower
- Shower Diverter, Hose and Head, Antique Brass Finish, with Slide Bar for Shower Head with Soap Dish
- New Style Shower Light on Wall inside Shower Area
- Antique Brass Shower Door Frame with Decorative Glass

### Options

- RV Sani-Con 2 System, Holding Tank Flush System with Hanging Bracket for Hose
- Bathtub IPO Shower

## Heating, Vents and Air Conditioning

- One 13.5M BTU and One 11.0 M BTU Air Conditioner with Ducted Air and Wall Analog Thermostat, Low-Profile Ford and Workhorse
- 35M BTU Electronic Ignition Furnace
- Electronic Dash AC/Heat Climate Control System
- In-Floor Ducted Heating System with Metal Floor Registers
- Kitchen Powered Attic Fan with Wall Control of Automatic Dome and Fan Power
- Bath Powered Attic Fan with Wall Control of Automatic Dome and Fan Power
- 12V Heater in Wet Bay, Heat Pad on Fresh Tank
- Metal Air Return Grill Furnace Antique Brass Finish
- Metal Floor Registers Antique Brass

### Options

- Dual 13.5M BTU Air Conditioners, Require 50 Amp Service, Low-Profile Ford and Workhorse
- Dual 13.5M BTU Air Conditioners with Heat Pumps, Require 50 Amp Service, Low-Profile Ford and Workhorse
- Fantastic 12V Attic Fan with Rain Sensor with Electronic Wall Thermostat in Kitchen
- Fantastic 12V Attic Fan with Rain Sensor with Electronic Wall Thermostat in Bath

## Windows, Doors and Awnings

- Radius Flush-Mount Dual Pane Windows/Safety Glass Dark Tinted
- Opera Window at Swivel Glider Barrel Chair Location
- Rear Wall Bedroom Window (33PBD, 37PBD, 37PCT)
- Bathroom Window (36DBD, 37PCT)
- Radius Entrance Door with Clear Glass, Roller Shade, Screen Door and Anti-Skid Steps
- Two Interior Grab Handles and One Exterior Grab Handle
- Topper Slide-Out Awnings Living Area and Bedroom
- Protecta Glaze Tinted Plexiglas® Skylight in Kitchen with Pleated Shade

- Protecta Glaze Tinted Plexiglas® Skylight in Bathroom
- Awning Rail

### Options

- Acrylic Patio Awning with Metal Cover
- Eclipse Automatic Patio Awning
- Acrylic Window Awnings on Living Area Slide-Out House Windows (Except Kitchen Windows)
- Bedroom Skylight (37PCT)
- Acrylic Side Window Awning Bedroom (34SBD, 36DBD)

## Safety

- Fire Extinguisher
- Deadbolt Lock on Entrance Door
- 120V GFI Protected Circuit, Kitchen, Bath and Exterior
- LP Gas Detector
- Smoke Detector

- Carbon Monoxide Detector
- Pilot and Co-Pilot Three-Point Seat Belts
- Third Brake Safety Light
- Egress Window(s)

## EASY DRIVING. EASY LIVING.

Our shorter 30PDD floorplan makes no sacrifices when it comes to features. Highlights include the exclusive Panaview™ 1-piece windshield, side-hinged baggage doors and a new one-piece peaked insulated fiberglass roof. You'll also enjoy more spacious living area, thanks to a new ceiling height of 7 feet and the new bedroom slide-out, increased to a depth of 30 inches.



## SIMBA 30PDD WEIGHTS &amp; MEASUREMENTS

**Weights (Workhorse 18,000 Lb. Chassis) (Lbs.)**

Gross Vehicle Weight Rating	18,000
Gross Combined Weight Rating*	22,000
Front Gross Axle Weight Rating	7,000
Rear Gross Axle Weight Rating	12,000

**Weights (Ford 20,500 Lb. Chassis) (Lbs.)**

Gross Vehicle Weight Rating	20,500
Gross Combined Weight Rating*	25,500
Front Gross Axle Weight Rating	7,000
Rear Gross Axle Weight Rating	13,500

**Weights (Workhorse 20,700 Lb. Chassis) (Lbs.)**

Gross Vehicle Weight Rating	20,700
Gross Combined Weight Rating*	25,700
Front Gross Axle Weight Rating	7,500
Rear Gross Axle Weight Rating	13,500

**Measurements**

Wheelbase	190"
Overall Length	31' 0"
Overall Height, Including A/C (Ford & 20,700 Lb. Workhorse)	12' 6"
Overall Height, Including A/C (18,000 Lb. Workhorse)	12' 4"
Interior Height	84"
Interior Width	94.5"
Exterior Width	100.5"

**Tank Capacities\*\* (Gal.)**

Water Heater	6
Gray Tank	42
Black Tank	42
Fresh Tank	60
LP Tank (Gal.) ***	24



\* Towing capacity is limited by GCWR; your vehicle's towing capacity is the difference between the GCWR and the actual vehicle weight, including all water, fuel, passengers and cargo. Your towed vehicle should be equipped with auxiliary brakes if the weight of the towed vehicle exceeds 1,000 lbs. Consult your Owner's Manual for further towing information.

\*\* All tank capacities are estimated based upon calculations provided by the tank manufacturers and represent approximate capacities. The actual "usable capacity" may be greater or less than the estimated capacities based upon fabrication and installation of the tanks.

\*\*\* Actual filled LP capacity is 80% of listing due to safety shut-off required on tank.



# 30PDD

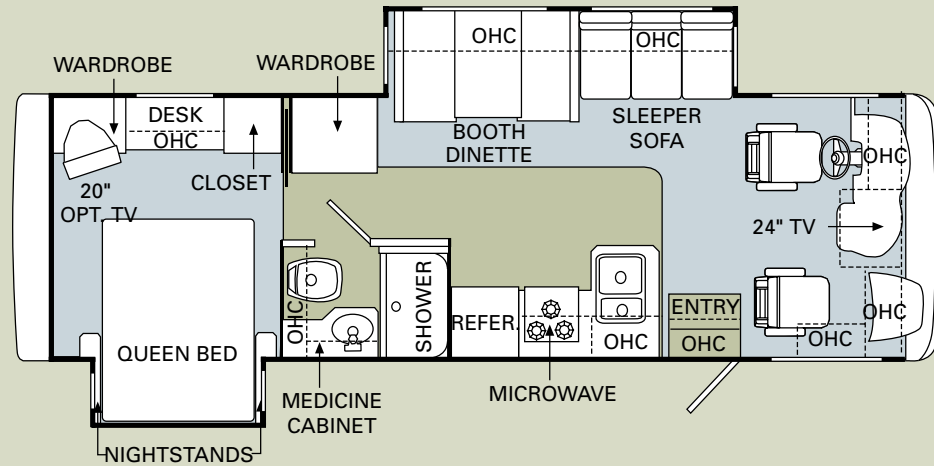

OPTIONS: New Style Fabric Hide-A-Bed Sofa with Two Pillows



Carpet Linoleum

## Body Construction

- Alumaframe® Superstructure
- Steel Cage Cockpit Construction
- Peaked One-Piece Fiberglass Roof with Fiberglass Insulation
- Smooth Aluminum Exterior Walls
- Front and Rear Molded Fiberglass Caps
- One-Piece Front Windshield
- Interior Height, 84"
- Aluminum Framed Floor on Steel Trusses
- Laminated Structurwood™ Flooring
- Interior Paneling with 3/4" Insulation
- Foam Insulated Floor Framing with 3-Ply Underbelly
- One-Piece Engine Cover
- Black Front Mounted Exterior Mirrors
- Fog Lights
- Low-Profile Sealed LED Marker Lights
- Integrated Metal Fuel Door with Lock
- Sofa and Dinette Slide-Out House to I47" Deep Slide
- 30" Deep Bedroom Slide-Out Houses
- Pass-Through Storage Bays under Slide-Outs with Roto Cast Boxes
- Side-Hinged Baggage Doors; All Door Locations with Redesigned Extrusion and Latch Locations
- One-Piece Polyethylene Storage Compartment
- Painted Skirt with Vinyl Exterior Graphics
- Rear Ladder
- Interior Rubber Entry Steps
- Exterior Double Entry Steps
- Undercoating

## Workhorse Chassis/Engine/Suspension (18,000 Lbs.)

- 8.1L V-8 Gasoline Engine with Electronic Fuel Injection
- Engine Displacement: 8.1L/496 Cu. In.
- Power: 340 HP
- Torque: 455 lbs./ft.
- 4-Speed Automatic Transmission with Overdrive
- Fuel Tank Capacity 75 Gallon
- I45 Amp Alternator
- Rear Axle Ratio: 4.63:1
- Radial Tires: 225/70R x 19.5F
- Stainless Steel Wheel Liners
- Leaf Spring Suspension
- ABS Brake System
- New Pre-Wire for Supplemental Braking System
- Hitch Receiver with Dual Connector 4-Pin or 7-Pin (Hidden Hitch) 4,000 Lbs.
- SmartStructure II

### Options

- Fully Automatic Hydraulic Leveling System

## Ford Chassis/Engine/Suspension (20,500 Lbs.)

- 6.8L 3-Valve V-10 Gasoline Engine with Electronic Fuel Injection
- Engine Displacement: 6.8L/415 Cu. In.
- Power: 362 HP
- Torque: 457 lbs./ft.
- TorqShift 5-Speed Automatic Overdrive Transmission with Tow/Haul Mode
- New Transmission Oil Temperature Gauge
- Fuel Tank Capacity 75 Gallon
- I30 Amp Alternator
- Rear Axle Ratio: 5.38:1
- Radial Tires: 245/70R x 19.5F
- Wheel/Rims: Chrome Wheel Covers
- Leaf Spring Suspension
- Front and Rear Disc, 4-Wheel Anti-Lock Brakes
- Heavy-Duty Front Track Bar with Bilstein® Shock Absorbers
- Pre-Wire for Supplemental Braking System
- Hitch Receiver with Dual Connector 4-Pin or 7-Pin/5,000 Lbs.
- SmartStructure II

### Options

- Fully Automatic Hydraulic Leveling System
- Stainless Steel Wheel Simulators, Standard on Workhorse Chassis

## Workhorse Chassis/Engine/Suspension (20,700 Lbs.)

- 8.1L V-8 Gasoline Engine with Electronic Fuel Injection
- Engine Displacement: 8.1L/496 Cu. In.
- Power: 340 HP
- Torque: 455 lbs./ft.
- 5-Speed Automatic Transmission with Overdrive
- Fuel Tank Capacity 75 Gallon
- 145 Amp Alternator
- Rear Axle Ratio: 4.88:1
- Radial Tires: 245/70R x 19.5F
- Stainless Steel Wheel Liners

- Leaf Spring Suspension
- ABS Brake System
- Pre-Wire for Supplemental Braking System
- Hitch Receiver with Dual Connector 4-Pin or 7-Pin/5,000 Lbs.
- SmartStructure II

### Options

- Fully Automatic Hydraulic Leveling System

## Cockpit

- Fiberglass Automotive Dash with Roman Bronze Instrument Panel and Two-Tone Dash Vinyl
- CD Player/Radio with Sirius-Ready Compatibility, Weather Band and Six Speakers
- Multi-Positioned Sunvisors
- Rear Vision System Prep
- Intermittent Windshield Wipers
- Tilt Steering Wheel
- Cruise Control
- Power Steering
- Electric Automotive Horn
- Wood Center Console on Engine Cover, Recess Tray with Rubber Mat and Plastic Two-Tier Cup Holders; Front Tip-Door Ford/Front Drawer Workhorse Chassis

- New Style Soft Touch Vinyl Pilot and Co-Pilot Recliner Seats
- Carpeted Driver and Passenger Floor Mats
- Dash Workstation
- Wood Framed Cabinet Doors with Smoked Glass over Front Entertainment Center Systems
- Secure Front Cab over TVs with Steel Framing

### Options

- Six-Way Power Pilot Seat
- Rear Vision System with Audio and Adjustable Camera

## Appliances and Accessories

- Double-Door Refrigerator
- High-Output Three-Burner Cooktop without Oven
- Bi-Fold Range Cover
- Microwave with Touch Control and Under-Mounted Range Hood
- 24" Flatscreen Stereo Color TV with Remote Control in Cockpit Overhead
- TV Antenna
- DVD Prep and Video Control Box with Booster
- Exterior Hook-Ups for DSS Dish and Cable

- Interior Cable TV Hook-Up and Telephone Jacks
- Digital Satellite System Prep
- Exterior Gas Line Hook-Up Prep for LP Accessories

### Options

- Large Double-Door Refrigerator
- High-Output Three-Burner Range with Oven
- 20" Stereo Color TV with Remote Control in Bedroom

## Interior

- New Vintage Oak Cabinetry
- Upper Cabinet Doors with Single Oval Arch with Woven Insert; Cockpit Side Cabinet Doors with Square Panel with Woven Insert; Flat Panel Doors on Base Cabinets and Wardrobes
- Cabinet End Panels
- Wood Grain Refrigerator Panel Insert
- Wallpaper Border in Kitchen and Rear Bedroom Wall
- Self-Supporting Top-Hinged Overhead Storage Doors and Positive Catches on All Other Doors
- Heavy-Duty Ball Bearing Drawer Guides
- Wood Cabinet Drawer Boxes
- Wood Interior Grab Handle on Cabinet at Entry Door
- Antique Brass Cabinetry Hardware and Bath Accessories
- Laminate Kitchen Countertop, Stainless Steel Sink, Brushed Nickel Faucet and Two Sink Covers
- Toe Kicks Kitchen and Bath Base Cabinets
- Laminate Bathroom Countertop with Laminate Perm-Edge; All Other Countertops are Laminate with Perm-Edge
- Kitchen Overhead Cabinets with Adjustable Shelf

- Silverware Drawer with Organizer Kitchen Base Cabinets (N/A with Range Option)
- Linoleum Flooring in Kitchen and Bath; Kitchen Flooring to Include Entry Door
- Upgrade Nylon Carpeting with Pad in Living Area and Bedroom
- Soft Touch Padded Vinyl Ceiling
- Wood Slide-Out Fascia with Vinyl Inserts
- Bathroom Lavatory Base Mirror with Wood Frame
- Bedroom Swing-Away TV Cabinets with TV Option
- Bedspread with Two Decorative Pillows
- New Fabric Headboard
- Pleated Day/Night Blackout Shades in Living Area and Bedroom
- Soil Repellent on Fabric

### Options

- New Decors: Red Rock, Rainforest, Smoke Tree
- Wood Choice: Newport Cherry, Champagne Select

## Furniture

- Queen Bed with Nightstands
- Bedroom Desk
- Arched Back Wood Booth Dinette with Side-Sliding Table Top
- Forward-Facing Seat Belts in Booth Dinette inside Living Area Slide-Out
- New Style Fabric Wall Hugger Sleeper Sofa, Two Pillows on All Sofas

### Options

- New Style Fabric Hide-A-Bed Sofa with Two Pillows

## Electrical Systems and Lights

- 30 Amp 120V Distribution Panel and Power Cord
- 60 Amp Electronic 12V Power Converter
- Onan® 4.0 kW Gas Generator
- Two 6V House Batteries
- Battery Disconnect Switches
- 12V and 110V Outlet in Cockpit Area
- Porch Light and Exterior Step Light on Same Switch
- Exterior Power Entry Step with Light
- Water Pump Switch in Service Bay Area and Convenience Center
- Lights in Outside Storage Compartments

- 120V Receptacles in Outside Storage Compartment
- Underhood Utility Light
- Receptacle and Phone Jack in Dinette Area
- Directional Map Lights Pilot and Co-Pilot Seats
- Decorative Antique Brass Finish Dinette Overhead
- Antique Brass Decorative Bathroom Wall Light
- Halogen Lights under Living Room and Dining Room Overhead Cabinets
- Reading Lights over Bed, Black Finish with His and Hers Switches on each Side above Nightstands

## Plumbing and LP Systems

- Kitchen Stainless Steel Sink with Single Lever Brushed Nickel Faucet
- Bath Lavatory Faucet Single Handle Antique Brass Finish
- Demand Water System and Water Pump
- 6 Gallon LP Gas/Electric Water Heater with Electronic Ignition, DSI
- Winterization Valving System
- Water Heater Bypass Valve
- Toilet with Sprayer
- No-Fuss Flush Holding Tank Rinsing System

- Insulated Systems Compartment with Easy Access to Hook-Up
- New Style Shower inside Wet Bay with Hot/Cold Water
- Gravity and Pressurized Water Fill
- Contained Storage Area for Sewer Hose
- One-Piece Fiberglass Shower
- Shower Diverter, Hose and Head, Antique Brass Finish, with Slide Bar for Shower Head with Soap Dish
- Antique Brass Shower Door Frame with Decorative Glass

## Heating, Vents and Air Conditioning

- One 13.5M BTU Air Conditioner with Ducted Air and Analog Wall Thermostat, Low-Profile Ford and Workhorse
- 35M BTU Electronic Ignition Furnace
- Electronic Dash AC/Heat Climate Control System
- In-Floor Ducted Heating System with Metal Floor Registers
- Living Area Powered Attic Fan with Wall Control of Automatic Dome and Fan Power
- Bath Powered Attic Fan with Wall Control of Automatic Dome and Fan Power

- 12V Heater in Wet Bay, Heat Pad on Fresh Tank
- Metal Air Return Grill Furnace Antique Brass Finish
- Metal Floor Registers Antique Brass

### Options

- One 15M BTU Air Conditioner with Ducted Air and Analog Wall Thermostat, Low-Profile Ford and Workhorse

## Windows, Doors and Awnings

- Radius Flush-Mount Single Pane Safety Glass Dark Tinted Slider Windows
- Radius Entrance Door with Clear Glass, Roller Shade, Screen Door and Anti-Skid Steps
- One Interior Grab Handle and One Exterior Grab Handle
- Topper Slide-Out Awnings Living Area and Bedroom
- Protecta Glaze Tinted Plexiglas® Skylight in Bathroom
- Awning Rail

### Options

- Acrylic Patio Awning with Metal Cover

## Safety

- Fire Extinguisher
- Deadbolt Lock on Entrance Door
- 120V GFI Protected Circuit, Kitchen, Bath and Exterior
- LP Gas Detector
- Smoke Detector

- Carbon Monoxide Detector
- Pilot and Co-Pilot Three-Point Seat Belts
- Third Brake Safety Light
- Egress Window(s)

## Live out loud.

Now we've done it. We've taken the luxury motorhome and given it a fun streak. And to top that, we've made it exceedingly affordable. Yes, we're happy to introduce the rebellious new 2006 Safari lineup. While we invite you to compare these super-sized values with other motorhomes, we won't be surprised if you cut to the chase and hit the road in a new Safari. Because we know how you love a great deal.



Cheetah

Trek®

Simba®



Live out loud.

[www.safarimotorcoaches.com](http://www.safarimotorcoaches.com)

91320 Coburg Industrial Way, Coburg, OR 97408

1.800.458.8735