

2006 Class C Motorhomes

Freedom
By Coachmen™



(295TH SHOWN)

Leader in the Great Outdoors®

Freedom
By Coachmen™

2006
Freedom
By **Coachmen™**

The Best Way to Enjoy America



(314SO Floorplan Shown w/Royal Onyx Decor Selection)



(295TH Floorplan Shown w/Spiced Parsley Interior Decor)



Designed to be the value leader in the Class C Motorhome market, the Freedom by Coachmen™ has earned its stripes. Large exterior storage bays and the Stow-N-Go™ rear garage storage on most models let you take it all with you. The interior is also well equipped with a double door refrigerator, deluxe pressed cabinet doors, high spout faucet, self edged countertops, and easy to clean vinyl flooring.

Decor Selections

Dazzling interiors feature skillfully coordinated upholstery and window treatments. Coachmen RV chooses only top-grade fabrics wear-dated as heavy-duty. These fabrics have been tested for durability beyond 15,000 double rubs (in and out action) to simulate heavy usage. An average chair in an American home is subjected to only 3,000 double rubs per year.

A. Main B. Accent C. Bedspread

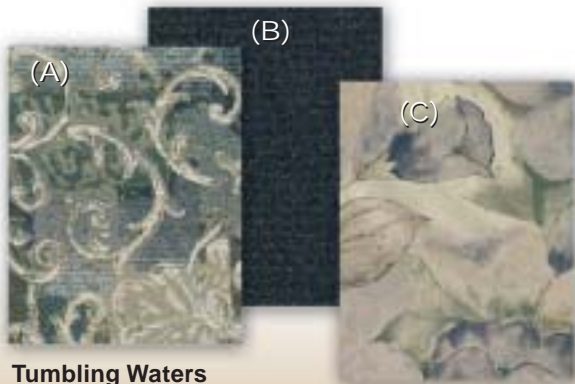

Tumbling Waters

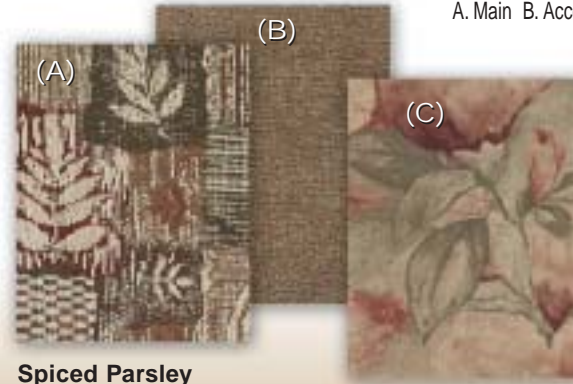

Spiced Parsley

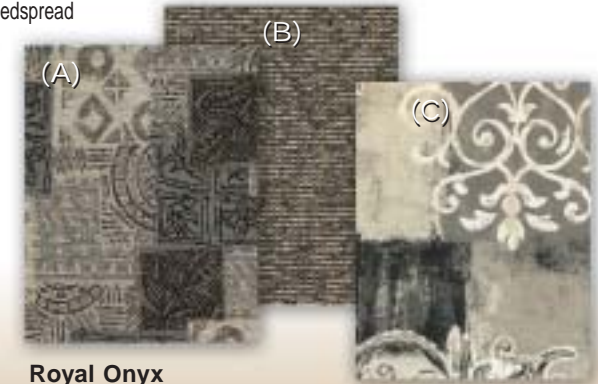

Royal Onyx

2006 Freedom Features Galore

By Coachmen™



Our standard **metal drawer guides with glide wheels** provide a friction free sliding drawer that is extremely durable. The drawer glides also act as a catch so that the drawer will not slide open during travel. Simply lift up and pull to open the drawers.



The Freedom 314SO features an enormous **side storage bay** that provides plenty of space for your stored gear.



SAFETY FIRST

Safety is paramount at Coachmen. All units come standard with an **LP leak detector, fire extinguisher, smoke detector and Carbon Monoxide detector.**



SAFETY FIRST

While the law requires only enough seat belts to equal the number of sleeping positions, Coachmen puts **seat belts at every fixed seating location.** All of our seat belts meet the FMVSS standards as stated by the government.



The **high spout faucet** is a nice residential touch that makes for simple cleanup of your taller pots and pans. You can also easily fill up your ice-tea jar on a hot summer day.



The handy **cockpit convenience area** features room for 2 large drinks, \$.05, \$.10, and \$.25 change holder, and extra miscellaneous storage for your essentials like sunglasses, road maps, and tissues.



The standard **double door refrigerator** is designed for maximum storage capacity with door storage and a handy freezer shelf. A convenient refrigerator light is also standard for those midnight cravings.

Ask Your Dealer About These Coachmen Exclusive Design Features

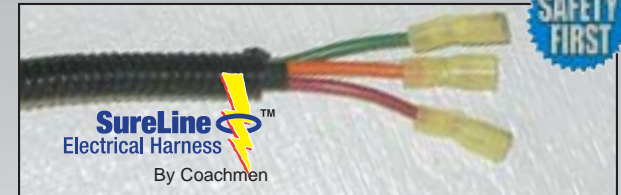

SAFETY FIRST

SureLine™
Electrical Harness
By Coachmen

Coachmen's **SureLine™ Electrical Harness** provides color coded wiring and specific wiring schematic for easy serviceability. High quality automotive electrical connectors and autoloom protective covering make for a reliable and durable harness. The wires are grouped together and neatly tucked into the framework under the coach, safe from road debris.



SAFETY FIRST

All Coachmen Class C Motorhomes utilize **Duratube™** full length copper LP lines with double flared ends to ensure a tight seal and

years of corrosion free use. We also run our copper lines, protected by a sleeve, through the frame, where they are protected from road damage.

It doesn't have to be a weekend project figuring out how to fill, drain, or winterize your RV. Our easy to use **Water Works™ Utility Panel** with large dials, simply displays how to perform each function. No lengthy explanations or wordy booklets are necessary (N/A 200 RB).



The large **Stow-N-Go™ garage storage** is standard on most

STOW-N-GO™
By Coachmen

models and provides an enormous amount of organized storage space.

Floorplans

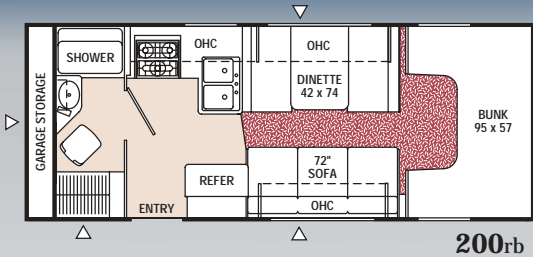

200rb

INDICATES CARPETING

INDICATES OUTSIDE STORAGE LOCATION

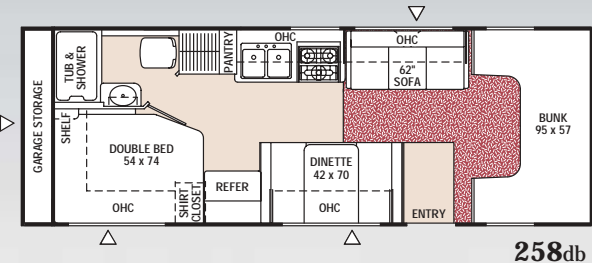

258db

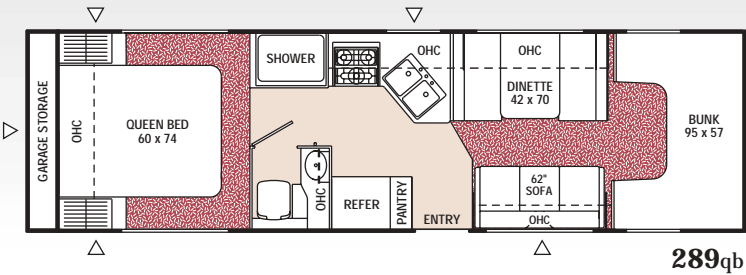

289qb

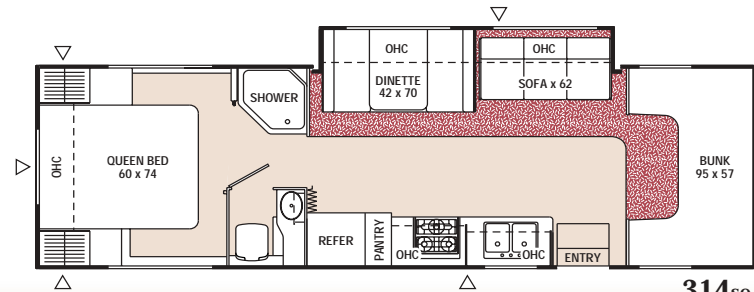

314so



Ramp & Camp

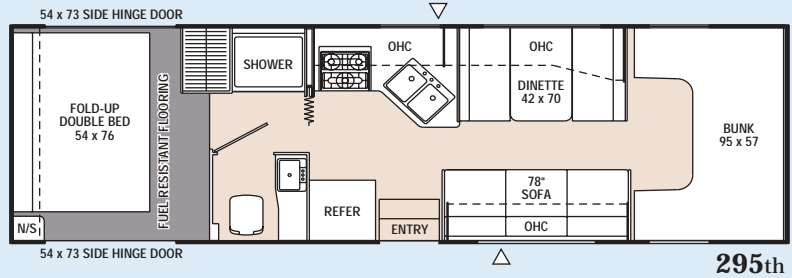

295th

- A** The double bed easily flips up to provide a large storage bay for your toys.
- B** With the rear bed down the cargo area becomes a spacious bedroom.
- C** The 12V-120psi air compressor is standard equipment on the 295TH.
- D** Track style tie downs provide a secure location for transporting your toys



	200RB	258DB	289QB	295TH	314SO
Chassis	CHEVY	CHEVY	CHEVY	FORD	FORD
Chassis Model	C-3500	C-3500	C-3500	E-45	E-45
Engine Size (liter)	6.0L	6.0L	6.0L	6.8L	6.8L
Wheel Base	139"	159"	191"	190"	208"
Rear Axle Ratio	4.10	4.10	4.10	4.56	4.56
Tire size	**	**	**	**	**
GVWR (pounds)	12,300	12,300	12,300	14,050	14,050
CW (pounds)	8,550	9,175	9,700	10,820	11,140
GAWR Front (pounds)	4,300	4,300	4,300	4,600	4,600
GAWR Rear (pounds)	8,600	8,600	8,600	9,450	9,450
GCWR (pounds)	16,000	16,000	16,000	20,000	20,000
Exterior Length	23'7"	27'2"	31'	29'6"	30'6"
Exterior Clearance Height*	10'11"	10'11"	10'11"	11'2"	11'2"
Exterior Width	8'3"	8'3"	8'3"	8'3"	8'3"
Sleeping Capacity	4	6	6	6	6
Interior Width	8'	8'	8'	8'	8'
Interior Height	6'8"	6'8"	6'8"	6'8"	6'6"/6'11"
Fuel Capacity (gal.)	35	35	35	55	55
Alternator Amps	145	145	145	130	130
Fresh Water Capacity (gal.)	27.5	39	57	27.5	40
Waste Water Capacity (gal.)	28	28	27	29	27
Grey Water Capacity (gal.)	28	27	28	28	27
Water Heater Capacity	6	6	6	6	6
LP Gas Capacity (lb.)	68	40	68	68	85
Furnace Rating (x 1,000) BTU	18	25	25	30	30

*Include Clearance for Roof A/C **LT225/75R16D † Estimated

GVWR (Gross Vehicle Weight Rating): The maximum permissible weight of the unit, including the UVW plus all fluids, cargo, optional equipment and accessories. For safety and product performance, do not exceed the GVWR.

CW (Curb Weight): The weight of the unit without factory or dealer installed options, plus allowance for the weight of full fuel capacity. The "payload capacity" for all other fluids, cargo, occupants, optional equipment and accessories can be determined by subtracting the CW from the GVWR.

GAWR (Gross Axle Weight Rating): The total weight each front/rear axle, suspension and tire system is designed to carry. When loading the unit, care should be taken to balance cargo weight in consideration of the GAWRs.

GCWR (Gross Combined Weight Rating): The maximum total weight of the loaded unit, plus a tow vehicle. This includes the weight of both the unit and tow vehicle, fuel for each, all other fluids, cargo, occupants, optional equipment and accessories.

Wider Widths: Numerous Coachmen floorplans feature the "wide body" design concept, which gives you significantly enhanced interior living space and innovative floorplans.

In making your purchase decision, you should be aware that a few states restrict access on some or all roads within the state to vehicle with a maximum 96" width, although special road usage permits may be available. Vehicles up to 102" in width are permitted in the vast majority of states. You should confirm the road usage laws in the states of interest to you before making your purchase decision. If width is of concern to you, we invite you to consider the broad array of other Coachmen models offered in the standard 96" width.

IMPORTANT NOTE: All capacities are approximate, and all dimensions are nominal. Coachmen motorhomes are designed to allow for a wide variety of uses, extended trips with two people or short trips with multiple people. Accordingly, each unit allows ample room for sleeping, seating, fluids and cargo. While the customer is the beneficiary of this design, the customer also bears the responsibility to select the proper combination of passengers, cargo, load, and tow vehicle without exceeding the chassis weight capabilities. Consumer may need additional braking capacity to tow loads greater than 1000 pounds.

Seat belts should always be worn for passenger safety. Seat belts are provided at most locations to allow convenience in selecting which seat to occupy. However, it is not intended that all seating positions equipped with a seat belt may be occupied while the vehicle is in motion, without regard to other weight factors.

All Coachmen motorhomes are designed to ensure that the number of passengers allowed while the vehicle is in motion will always at least equal the stated sleeping capacity. Though extra seat belts may be provided, for your safety and the proper operation of your vehicle, limit your passengers to the number allowed by the Net Carrying Capacity of your vehicle.

All information contained in this brochure is believed to be accurate at the time of publication. However, during the model year, it may be necessary to make revisions and Coachmen reserves the right to make all such changes without notice, including changes in prices, colors, materials, equipment and specifications, as well as the addition of new models and the discontinuance of models shown in this brochure. Therefore, please consult with your Coachmen dealer and confirm the existence of any materials, design or specifications that are material to your purchase decision.

QUALITY BY DESIGN



Coachmen RV is committed to providing a high quality, reliable, and innovative product. We know that quality extends far beyond the "glitz" of a recreational vehicle and often, the most important aspects of quality are hidden in the design and construction of the coach. That's why Coachmen designs quality into our products up-front, through computer aided design and analysis software. This helps to assure appropriate weight distributions, structural integrity, alignment of the various parts and components and overall reliability of the design.

Our attention to quality does not stop on the computer screen, as all of our major product designs undergo rigorous road tests, rain booth testing, complete compliance audits for all codes, standards and safety related items, and comprehensive product audits.

Coachmen designs, builds and markets a superior product, for reasons that may not always be easy to see, however are very easy to appreciate down the road. Our hidden quality equates to high value, which can be critical to your long-term satisfaction.

Standards & Options

Standard Features

INTERIOR APPOINTMENTS

- Olympic Oak Cabinets
- Residential Metal Drawer Glides
- TechWood® Drawer Sides
- Linoleum Flooring Throughout (N/A 295TH & 314SO)
- Linoleum Flooring – Kitchen & Bath (295TH & 314SO)
- Fuel Resistant Flooring (295TH Cargo Area)
- Mini Blinds Throughout
- Radius Slider Windows-Safety Glass
- Jack Knife Sofa
- Booth Dinette
- Reclining Pilot & Passenger Seats

INTERIOR EQUIPMENT

- AM/FM CD Player w/4 Speakers
- 20" Flatscreen Color TV- Coach (295TH)
- TV Antenna and Rotor Package
- LP Leak Alarm
- Smoke Detector
- Carbon Monoxide Detector
- Fire Extinguisher

GALLEY

- Residential Size Microwave Oven
- 3-Burner (High Output) Range Top
- Power/Lighted Range Hood
- Double Door Refrigerator
- Freezer Shelf & Refrigerator Light
- Monitor Panel
- Stainless Steel Kitchen Sink

SLEEPING

- Queen Bed (289QB, 314SO)
- Corner Double Bed (258DB)
- Fold-Down Double Bed (295TH)
- Cabover Bunk
- High Density Foam Mattress
- Bedspread & Pillow Shams (N/A 200RB, 295TH)
- Privacy Drape - Bedroom (N/A 200RB, 295TH)
- Privacy Drape-Lower Cab

BATH AND WATER

- Power Bath Vent
- 6-Gallon E.I. Water Heater
- Demand Water Pump
- Lavatory Sink
- Medicine Cabinet
- Glass Shower Enclosure (295TH, 314SO)
- Outside Shower (295TH)

ELECTRICAL/HEATING/AC

- 30 Amp. Power Cord
- 35 Amp. Power Center (200RB, 258DB)
- 55 Amp. Power Center (289QB, 295TH, 314SO)
- Auxiliary Battery
- GFI Circuit
- Outside 120V Receptacle (DS)
- Patio Light
- 18,000 BTU E.I. Furnace (200RB)
- 25,000 BTU E.I. Furnace (258DB, 289QB, 295TH)
- 30,000 BTU E.I. Furnace (314SO)
- 13,500 BTU Roof Air Conditioner
- Wall Mounted Thermostat

AUTOMOTIVE/EXTERIOR

- 35-Gallon Fuel Tank (200RB, 258DB, 289QB)
- 55-Gallon Fuel Tank (295TH, 314SO)
- Cruise Control
- Tilt Steering Wheel
- Dash Air Conditioning
- Exterior Mirror Upgrade
- Chrome Front Bumper
- Rear Bumper with Stabilizer Jacks (295TH, 314SO)
- Radial Tires
- Laminated Floor & Laminated 1½" Sidewalls
- Crowned, Laminated Roof
- Dead Bolt Lock Entrance Door
- Stow-N-Go™ Rear Storage Garage (N/A 295TH, 314SO)
- Radius Entrance Door
- Patio Awning
- Warehouse Storage (289QB, 314SO)
- Basement Storage (314SO)
- Power Windows & Locks (295TH, 314SO)
- Ramp-N-Camp™ Rear Toy Storage w/Ramps (295TH)
- Remote Exterior Spotlight (295TH)⁽⁵⁾
- Onboard 12V 120psi Air Compressor w/Inflator Kit (295TH)⁽⁵⁾



Optional Equipment

- Freedom Package (Std. 295TH)
Includes:
 - Partial Carpet w/Pad
 - Cable TV Jack
 - Privacy Drape - Cabover
 - Emergency Start Switch
 - Aluminum Running Boards
 - Wheel Covers
 - Spare Tire
 - Hitch
 - Owner's Information Guide ⁽²⁾
- Night Shades Throughout (Std. 295TH)
- Front Cabover Entertainment Center (314SO) ⁽⁴⁾
- Front Cabover Window (200RB, 258DB, 289QB, 314SO)
- 24" Flat Screen Color TV – Coach (314OS) ⁽³⁾
- Fabric Accordion Door – Bedroom (289QB, 314SO)
- 3-Speed Power Roof Vent – Bedroom (289QB, 314SO) (Std. 295TH)
- 4.0 KW Gas Generac Generator (Std. 295TH)
- Slideout Room Awning (314SO)
- Single Battery Upgrade (Std. 295TH)
- Battery Disconnect (Std. 295TH)
- CSA Upfit ⁽¹⁾

Discover The Coachmen Advantages



Service After the Sale

- **Industry Leading Buckstopper™ Warranty** – Coachmen's exclusive Buckstopper™ Limited Warranty provides one-year coverage on most parts, components and appliances. Coachmen stands behind their product and is supported by a network of over 300 service centers.
- **Two Year Structural & Major Components Manufacturer's Warranty** – Coachmen provides a two-year structural and major components manufacturer's warranty, along with a complete written Warranty Summary Guide, for your peace of mind.
- **Comprehensive Owner's Information Guide** – For your convenience we offer published



materials on key equipment and options, as well as information pertaining to the function of important components. We also offer a true **Trouble Shooting & Maintenance Guide** for the simple answers to frequently asked questions.

- **Toll Free Service Numbers** – Our toll free phone numbers provide you with direct access to a Coachmen RV Service Representative.
- **Dealer Support Tools** – Coachmen makes sure that their dealers are well equipped and trained to service your needs with: Systems Manuals, PDI Manuals, Electronic Parts Catalogs, Coach-

Link® "On-Line" Electronic Dealer Communication System, and continual service training.

- **Service Support Center Web Site** – Coachmen provides you access to key information 24-hours a day through the Internet. On-line you can find a Service Dealer Locator, Maintenance Information, Trouble Shooting Information, Product Warranty Information, Customer "E-Assistance", Frequently Asked Questions (FAQ's), and Publications ordering dating back to 1972 models.
- **Priority Parts Ordering** – Coachmen provides a program for overnight parts shipment in critical repair situations.

Coachmen Caravan Camping Club™ Coachmen Caravan Camping Club is your ticket to making friends for life. Share old stories and make new, in the company of fellow Coachmen Caravan members. With the purchase of a Coachmen RV, you are invited to join one of the nation's largest manufacturer sponsored RV clubs with a FREE 1st year membership. As part of the Coachmen Caravan family, you will receive incredible membership benefits that will help to ensure your safety and enjoyment throughout your RV experiences. Enjoy your Coachmen RV more with the Coachmen Caravan Camping Club.

Leader to the Great Outdoors®

Coachmen RV Company is a proven leader in the RV Industry with over 40 years of experience. We are dedicated to providing a high quality, reliable, and innovative product backed by high quality service support. Our mission is simple ... to meet and exceed your expectations and to make your total RV experiences memorable and enjoyable!

*Coachmen RV Company ... A Great Product, A Great Company, A Great Name!
Coachmen RV Company ... Leader to the Great Outdoors®*



Visit our website at: www.coachmenrv.com

Coachmen Recreational Vehicle Company, LLC
P.O. Box 30, Middlebury, IN 46540 • P.O. Box 948, Fitzgerald, GA 31750