

PRESIDENTIAL

2010



HOLIDAY RAMBLER®

This is Living®



Presidential



36RET

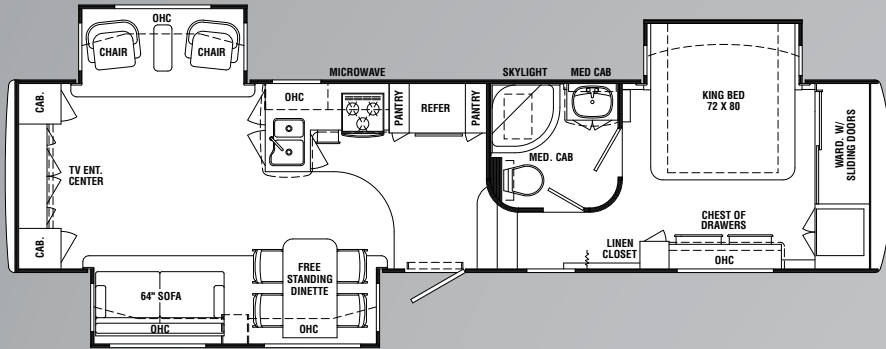

Gross Vehicle Weight Rating	16,950
Hitch Weight	680
Axle(s) Weight Rating	7,000
Unloaded Vehicle Weight	10,394
Net Carrying Capacity (NCC)	6,556
Tire Size and Load Range	16" G
Overall Length	36' 10"
Overall Height (Including A/C)	TBD
Exterior Width	TBD
Water Heater	10
Grey Tank	50/50
Black Tank	50
Fresh Tank	70
L.P. Tank**	30 (2)

37SKQ

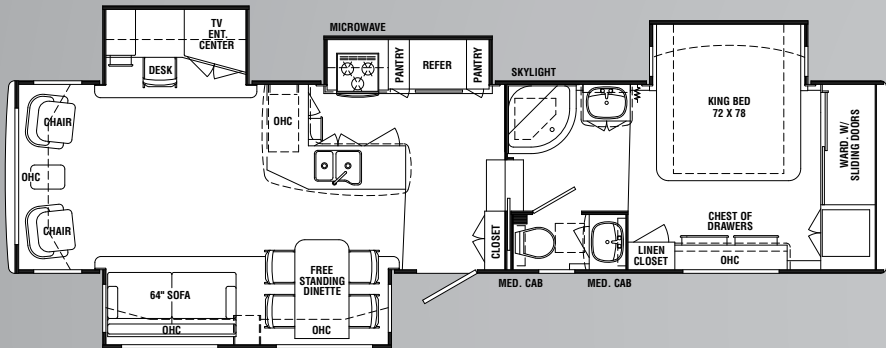

Gross Vehicle Weight Rating	16,950
Hitch Weight	TBD
Axle(s) Weight Rating	7,000
Unloaded Vehicle Weight	TBD
Net Carrying Capacity (NCC)	TBD
Tire Size and Load Range	16" G
Overall Length	37' 1"
Overall Height (Including A/C)	TBD
Exterior Width	TBD
Water Heater	10
Grey Tank	40/50
Black Tank	50
Fresh Tank	70
L.P. Tank**	30 (2)

37SKT

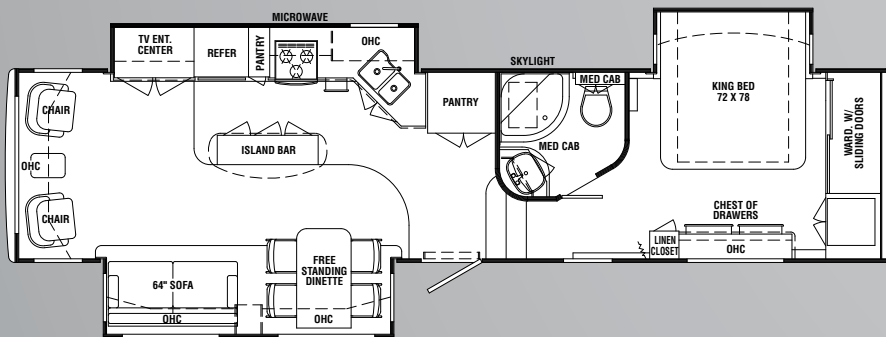

Gross Vehicle Weight Rating	16,950
Hitch Weight	TBD
Axle(s) Weight Rating	7,000
Unloaded Vehicle Weight	TBD
Net Carrying Capacity (NCC)	TBD
Tire Size and Load Range	16" G
Overall Length	37' 1"
Overall Height (Including A/C)	TBD
Exterior Width	TBD
Water Heater	10
Grey Tank	50/50
Black Tank	50
Fresh Tank	70
L.P. Tank**	30 (2)

Due to continuous product improvement, please see the website for the latest in standards and options, specifications, and technical data.
Go to www.holidayrambler.com.

* Towing capacity is limited by GCWR; your vehicle's towing capacity is the difference between the GCWR and the actual vehicle weight, including all water, fuel, passengers and cargo. Your towed vehicle should be equipped with auxiliary brakes if the weight of the towed vehicle exceeds 1,000 lbs. Consult your owner's manual for further towing information.

** All tank capacities are estimated based upon calculations provided by the tank manufacturers and represent approximate capacities. The actual "usable capacity" may be greater or less than the estimated capacities based upon fabrication and installation of the tanks.

*** Actual filled LP capacity is 80% of listing due to safety shut-off required on tank.

STANDARDS

BODY CONSTRUCTION:

- > Z-Frame Superstructure
- > 7,000 lb. Tandem Axles with 12" Electric Brakes and Ultra-lube Hubs
- > Equa Flex Suspension System
- > Shock Absorbers
- > Aluminum Wheels
- > 16" Radial Tires
- > Spare Tire with Carrier Under Frame
- > Front Stabilizer Jacks with Snap Pins
- > Frame Mounted Entry Step (Triple) - with Radius Steps
- > Enclosed and Heated Underbelly
- > Aluminum Framed Bathroom Floor
- > Heated and Insulated Alcove Storage Underbelly
- > Laminated Walls with Foam Block Insulation
- > Laminated Sidewall with Block Foam Insulation
- > Flat Floor Slide-Out - Main Living Area
- > Main S/O House, 6'-6" Head Room
- > Slide-Out Lock Down Arms
- > Front and Rear Molded Fiberglass Cap
- > High Gloss Gel Coat Laminated Fiberglass Sidewalls
- > Exterior Rear Ladder

APPLIANCES AND ACCESSORIES:

- > 8 Cu. Ft. Refrigerator
- > 30" Space Saver Microwave with Touch Control
- > Wedgewood High Output 3-Burner Range with Oven
- > Bi-Fold Range Cover (Black)
- > Systems Monitor Panel
- > 37" LCD TV with Remote Control - Living Room
- > Home Theater Surround Sound System
- > Cable TV/DSS with Video Box
- > TV Antenna
- > Washer and Dryer Prep

INTERIOR:

- > Raised Panel Cabinet Doors Throughout
- > Raised Panel Refrigerator Door
- > Full Extension Roller Bearing Drawer Guides Throughout
- > Wallpaper Border Kitchen
- > Solid Surface Countertop with Waterfall Edge Treatment
- > Molded One Piece Kitchen Sink with Brushed Nickel High Profile Single Handle Faucet with Sprayer and Sink Covers
- > (2) Two Roll-Out Kitchen Pantries with 3 Baskets in Each Pantry; (1) One Roll-Out Pantry Deleted with 12 Cu. Ft. Refer Option (N/A 37SKT)
- > (1) One Roll-Out Kitchen Pantry with 3 Baskets; Pantry Deleted with 12 Cu. Ft. Refer Option (37SKT)
- > Wood Grain Countertops All Other Locations Other Than Kitchen and Bath
- > Decorative Slide-Out Room Fascia with Trim and Accents
- > Wood Grain Crown Molding at Ceiling Throughout
- > Linoleum in Kitchen, Bathroom and Entry Area
- > Utility Center Above Entrance Door with Slide-Out Switches, Tank Monitors, Security Light Switches, and Water Heater Switch
- > Radius Wood Soffit with Swivel Bullet Lights Inside Bedroom Slide-Out Box.

- > Designer Accessory Pillow Package
- > Pleated Day/Night Shades in Living Area and Bedroom

ELECTRICAL SYSTEMS AND LIGHTS:

- > 50 Amp Electrical Management Service
- > Detachable Marine Power Cord
- > Exterior Cable/Satellite Hook-Ups
- > Electrical Outlet in Basement Storage Under Bath Deck
- > Two (2) Exterior Security Lights - Individual Lighted Switches in the Utility Center
- > Battery Disconnect and Battery Box
- > Decorative Wall Light in Living Area at Sofa Location
- > Decorative Ceiling Mount Dinette Light
- > Decorative Bath Lavatory Light
- > (2) Two Recessed Flush Mounted Halogen Lights in Ceiling Above Sofas and Recliner Chairs
- > (2) Two Recessed Flush Mounted Halogen Lights in Ceiling Above Entertainment Center (N/A 37SKQ and 37SKT)
- > (2) Two Recessed Flush Mounted Halogen Lights in Front of Bedroom Wardrobe.

HEATING, VENTS AND AIR CONDITIONING:

- > One Carrier 15,000 BTU Rooftop Air Conditioner with Remote Control
- > 40M BTU Hydro Flame Electronic Ignition Furnace
- > In-Floor Ducted Heating System
- > Ceiling Fan with Light
- > Wire Prep and Ducting for 2nd Air Conditioner
- > Fantastic Fan - Bedroom

WINDOWS, DOORS AND AWNINGS:

- > Dark Tinted Radius Windows
- > Tinted Skylight in Bathroom
- > Patio Awning
- > Radius Main Entrance Door with Anti-Skid Steps
- > Swing-Out Entry Door Handle

PLUMBING AND L.P. SYSTEMS:

- > Molded One Piece Kitchen Sink with Brushed Nickel High Profile Single Handle Faucet with Sprayer
- > Bathroom Sink with Brushed Nickel Faucet and Lever Handles
- > One-Piece Fiberglass Radius Shower with Obscure Glass Door - Brushed Nickel
- > Hand Held Brushed Nickel Shower Fixture with Hose and Lever Handles
- > Porcelain Bowl Toilet - Foot Pedal Flush
- > 10 Gal. L.P. Gas/Elect. with DSI Water Heater
- > Two 30 lb. L.P. Tanks with Automatic Changeover
- > Water Heater By-Pass Kit
- > No-Fuss Flush Holding and Tank Rinsing System
- > Lighted Water Management System with Drain, Spray-Port Water Sprayer with 15' Polyurethane Hose, Outside Shower with Hot and Cold, Soap Dispenser, Paper Towel Holder

FURNITURE:

- > Bedroom in Slide-Out with Chest of Drawers at Foot of Bed

- > Fabric Hide-A Bed Sofa with Air Mattress
- > (2) Two Fabric Glider Recliner Chairs
- > High Back Desk Chair (N/A 36RET and 37SKT)
- > Free-Standing Dinette Table with Four Wood Chairs

OPTIONS

- > Steel Pull Out Storage Tray in Storage Area
- > Air Ride Pin Box
- > Electric Rear Fold Down Stabilizer Jacks
- > Canadian RV Certification
- > 10 Cu. Ft. 2 Way Refrigerator with Ice Maker
- > 12 Cu. Ft. Side by Side Refrigerator with Ice Maker
- > 30" Space Saver Convection Microwave with Touch Control
- > 19" LCD TV with Remote Control - Bedroom
- > Electric Fireplace below Living Room TV
- > Combination Washer/Dryer
- > Built-in Vacuum with Deluxe Tools
- > Décor Choices: Linen, Jewel, Harvest, and Carmine
- > (1) 12V Deep Cycle Battery with Disconnect
- > (2) 12V Deep Cycle Batteries with Disconnect
- > Solar Prep
- > Generator Prep
- > 5.5 KW Onan Marquis Gold LP Generator (Requires Generator Prep)
- > One Carrier 15.0 High Capacity Heat Pump Rooftop A/C with Remote Control
- > Second, Carrier 13,500 BTU Rooftop A/C with Remote Control
- > Second, Carrier 15.0 High Capacity Heat Pump A/C with Remote Control
- > Dual Pane Windows Radius with Dark Tint
- > Electric Patio Awning with Metal Cover
- > Slide-Out Topper Awning Living Room (Sofa and Dinette Slide)
- > Slide-Out Topper Awning Living Room (N/A 37SKT)
- > Slide-Out Topper Awning Kitchen (N/A 36RET)
- > Slide-Out Topper Awning Bedroom
- > Water Filter System to Kitchen Faucet
- > 40# L.P. Tanks IPO 30# L.P. Tanks.
- > Queen Bed with Nightstand on Right Hand Side of Bed
- > Rear Wall Living Room: Fabric Hide-A Bed Sofa with Air Mattress IPO (2) Two Fabric Glider Recliner Chairs (N/A 36RET and 37SKT)
- > (2) Two Leatherette Glider Recliner Chairs IPO (2) Two Fabric Glider Recliner Chairs
- > (2) Two Ultima Vinyl Euro Chairs with Ottoman IPO (2) Two Fabric Glider Recliner Chairs



HOLIDAY RAMBLER®

This is Living®

BEING DIFFERENT MAKES ALL THE DIFFERENCE.

At Holiday Rambler, it's our goal for all our customers to enjoy their RV experience from the beginning. We have forged strong, reliable relationships with our dealer partners, and we encourage our customers to do the same. We're proud to boast a network of over 350 dealership partners and service centers across North America. We're confident that this relationship will only enhance your RV experience and provide the added peace of mind you desire, so you can focus on the important stuff. After all, we're not just selling a world-class product, we're selling "fun". You can rest assured, Holiday Rambler will be along for the ride, every mile your RV adventure takes you.

PRESIDENTIAL

ALUMASCAPE

SAVOY LX

MINTARO

CAMPMASTER

The actual overall length of the recreational vehicle may differ from that indicated in the brochure due to variances in the manufacturing process and/or installed components. The actual length may be greater or less than that indicated. Due to the large variety of options and floorplan arrangements available to our customers, actual weights for each unit can differ significantly. Monaco provides a weight sticker on each unit we produce which includes that unit's tank capacities and approximate weight. Consult your local Monaco dealer for unit availability and further information. The information printed in this brochure reflects product design, fabrication, and component parts at the date of printing. The manufacturer reserves the right, at any time, to make changes in product design or material or component specifications as its sole option, without notice. This includes the substitution of components of a different brand or trade name which will result in comparable performance. All information printed in this brochure is subject to change after the date of printing. Some features shown or mentioned in this brochure are optional and may only be available in selected floorplans. Photographs may show props or decorations that are not standard equipment. Monaco, the Monaco logo and its design, are registered trademarks. Other products and company names are trademarks and/or registered trademarks of their respective holders. While the color of the motorhome's exterior and the interior fabrics depicted in this sales brochure are fair and reasonable depictions, the colors depicted may not be an exact match of the actual colors because of the variances in photo-processing and printing. Due to product improvements, changes during the model year and/or transcription errors that may occur, information represented within this brochure may not be accurate at the time of your purchase. If certain information is significant to your purchasing decision, please confirm the information with your dealer. Component part and appliance manufacturers issue limited warranties covering portions of the recreational vehicle not covered under the Limited Warranties issued by Monaco RV, LLC. To learn specific details regarding warranty coverage, please contact your selling dealership or review the warranty packet inside the recreational vehicle.