

 BEAVER 2005 MARQUIS®

ONE COACH AT A TIME.

YOURS.



 BEAVER 2005 MARQUIS®

In all this luxury, what's the first thing you see? Yourself.

You can't help it. As you look around the most refined motorcoach ever built, you immediately imagine yourself living the lifestyle it has to offer. Because it's a world where every detail is artfully crafted — with the time and attention we'd put into our very own homes.

If spaciousness is one of your first impressions, you're not being fooled. In fact, this year we've raised the coach's interior height to 81" — which is further enhanced by the



beautiful new tiered ceiling design. No doubt, you've also noticed the stunning woodwork, the result of our one-of-a-kind seven-layer process that's polished to

absolute perfection. The cabinets feature solid wood, raised panel doors with hidden hinges and adjustable, carpet-lined shelves.

Other highlights of the living area include decorative hardwood slide-out fascia, Corian® window sills and beautiful sculptured carpeting.



45' Jade shown in Copper Patina decor with Maple cabinets and Mappa Burl inlays.



2

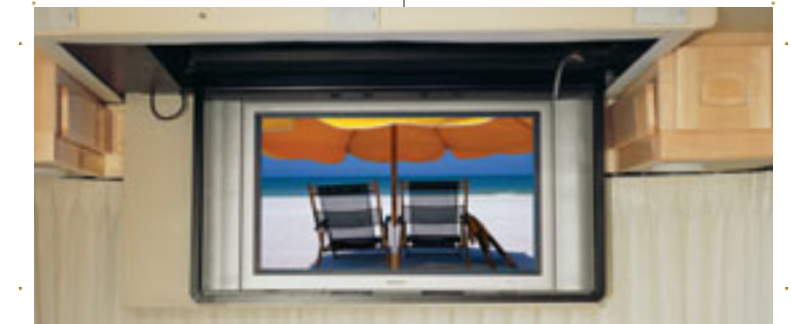

3

1. The Marquis features this beautiful round wood table with 12" leaf, two freestanding chairs and two handy folding chairs. **2.** Here, the living area is shown in Copper Patina decor with Maple and Bird's-Eye Maple inlay woodwork. **3.** You'll love this optional 37" LCD TV that drops from the ceiling at the touch of a button. It makes the perfect companion to the exciting new home theater system with surround speakers. In addition, a new universal remote system allows you to manage all your entertainment features with ease.

The choice is yours.



Beaver coaches have always been known for giving you more ways to create a coach that's distinctively your own. This year, the Marquis is available in five color schemes with stunning fabric combinations, including the exquisite Birds of Paradise by Paloma

Picasso. In addition, you have your choice of a wide selection of innovative double, triple and quad slide-out floorplans, in lengths ranging from 40' to 45', with numerous furniture options to fit your lifestyle. Now, it's all up to you.

BETTER
STAIN
PROTECTION



Manufactured in, not added on. For added protection against stains, Dupont Teflon® soil repellent is applied to virtually all upholstery fabric during the finishing process for superior coverage.*

*Brand and application of upholstery fabric protection may vary depending on date recreational vehicle was manufactured.

Marquis Designer Series "Birds of Paradise" by Paloma Picasso

SOFA

DINETTE

BEDSPREAD

CARPET

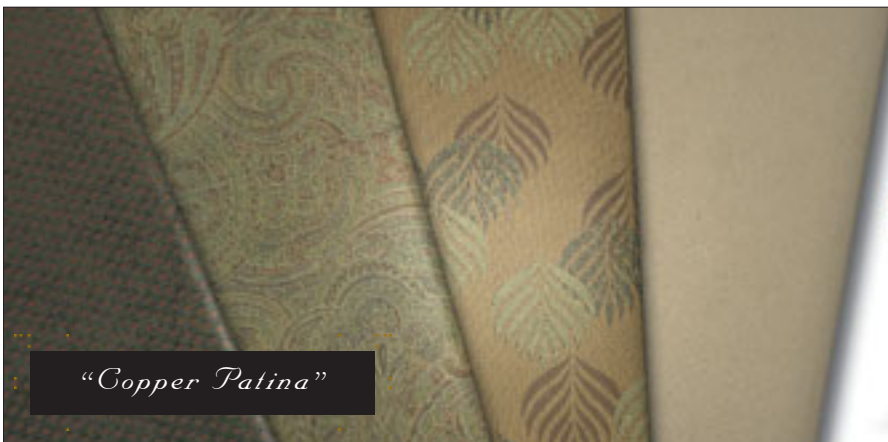
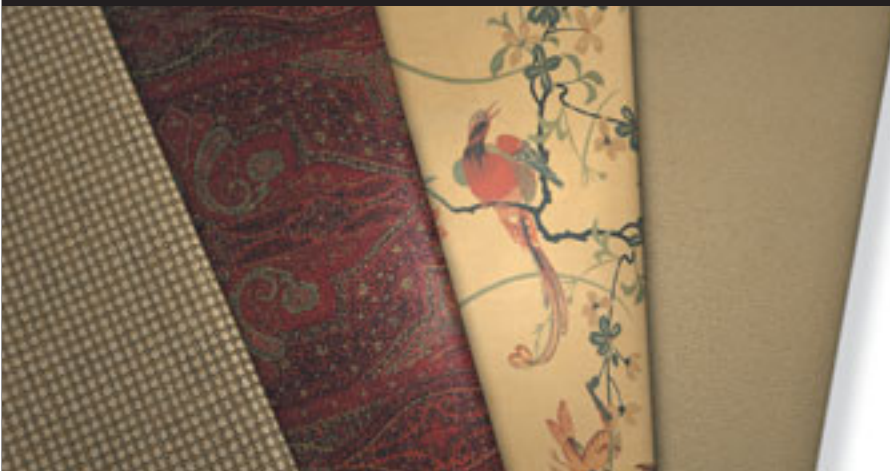

"Copper Patina"

SOFA

DINETTE

BEDSPREAD

CARPET





"Golden Amber"

SOFA DINETTE BEDSPREAD CARPET

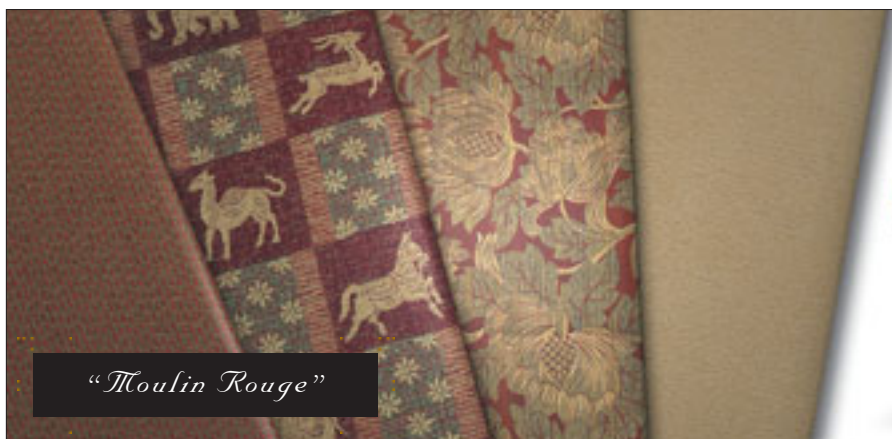

"Moulin Rouge"

SOFA DINETTE BEDSPREAD CARPET

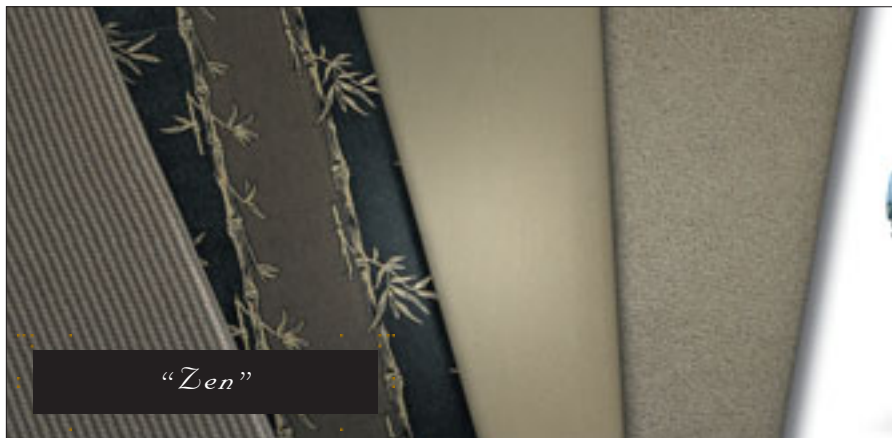

"Zen"

SOFA DINETTE BEDSPREAD CARPET



This is how you know it's a Marquis.

Our love affair with beautiful hardwoods from around the world continues to inspire the most stunning cabinetry you'll find anywhere. This year we're offering a selection of new styles, including gloss finishes in Cherry, Mahogany, and Maple, as well as cabinet door accents in Maple Burl, Mappa Burl, Makori and Bird's-Eye Maple.

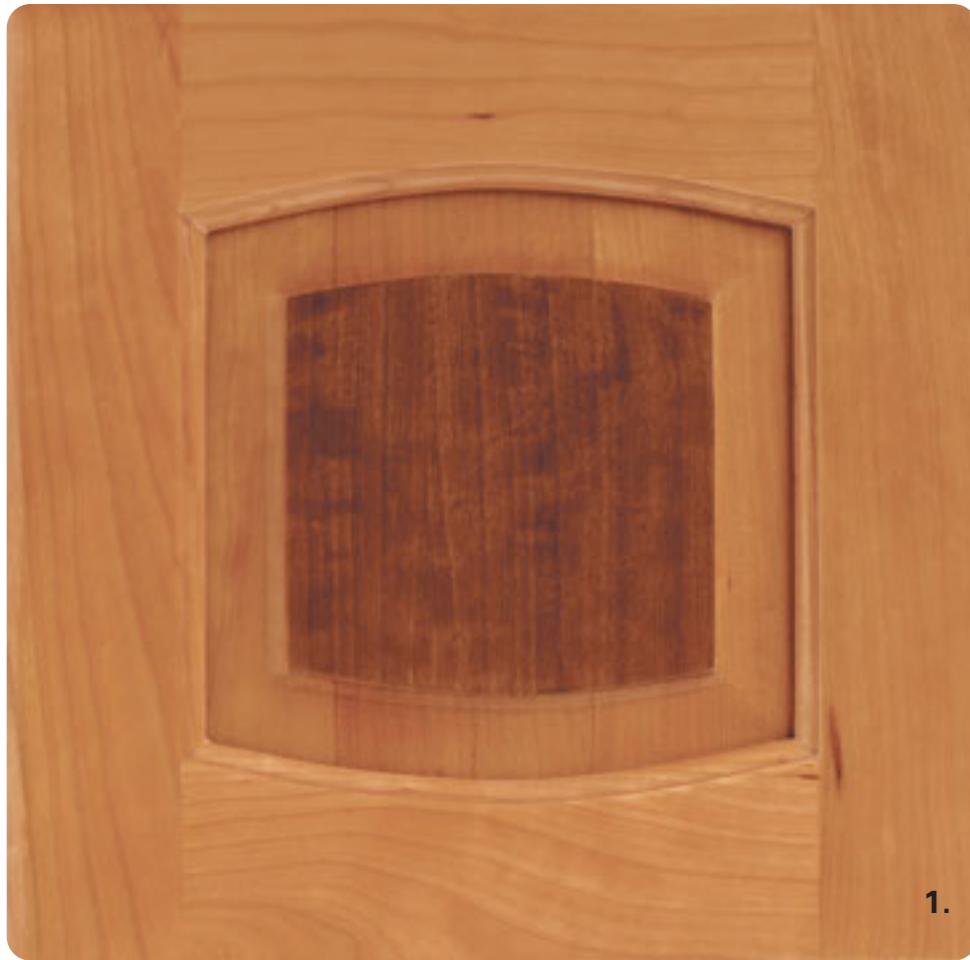

High gloss Euro-finish with exotic wood inlays in all doors and drawers in living room and kitchen area.

1. Cherry with Makori inlay 2. Maple with Bird's-Eye Maple inlay 3. Mahogany with Maple Burl inlay 4. Maple with Mappa Burl inlay

2005 Marquis Floorplans and Options

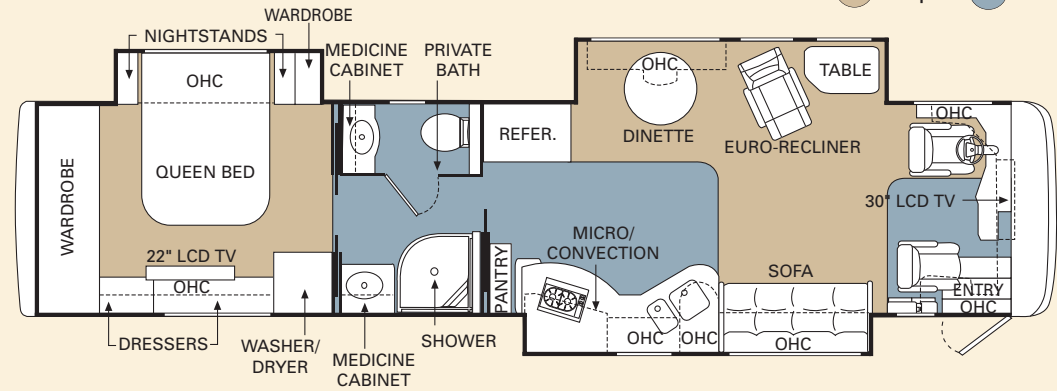
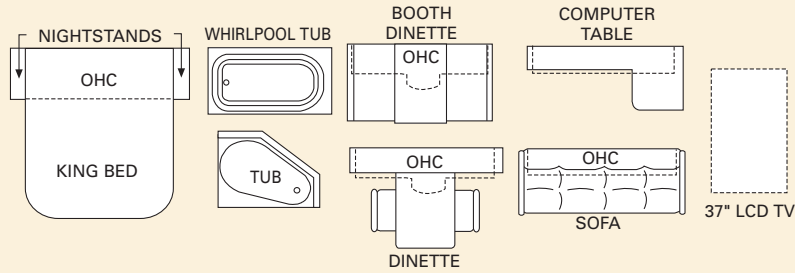

40' Ruby

40' Ruby Floorplan Options

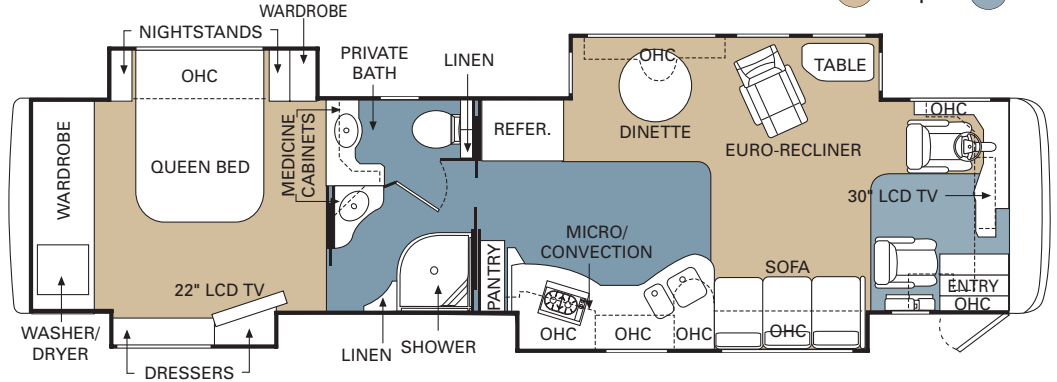
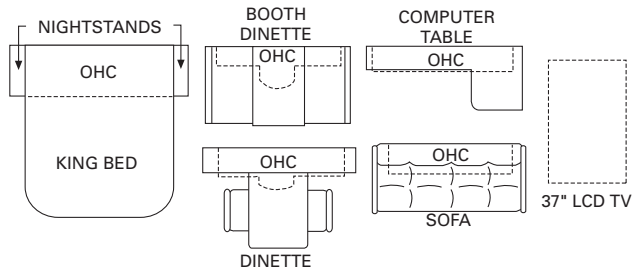

40' Pearl

40' Pearl Floorplan Options

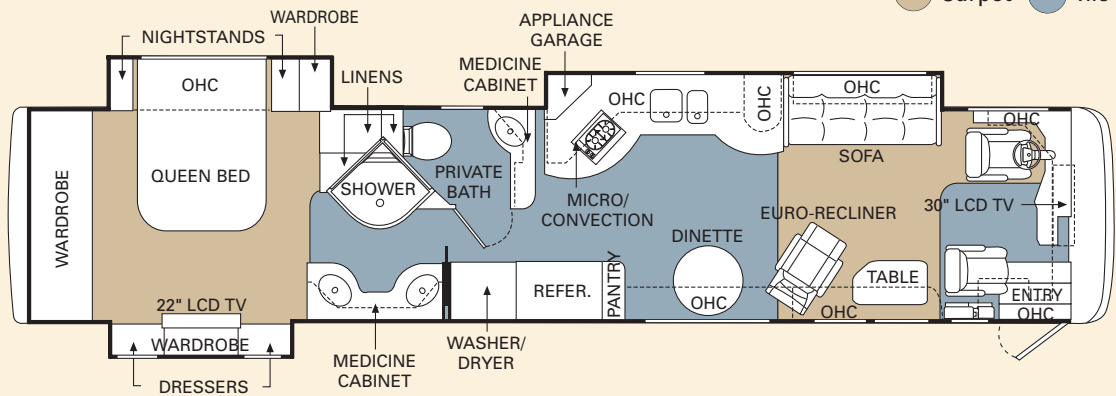
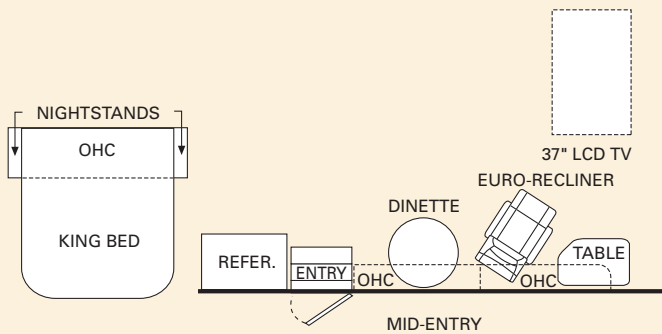

42' Amethyst

42' Amethyst Floorplan Options

2005 Marquis Floorplans and Options

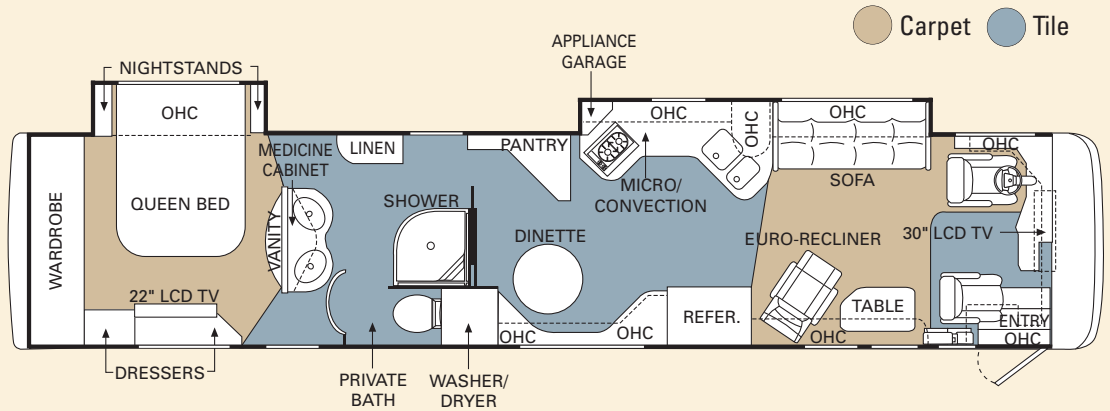
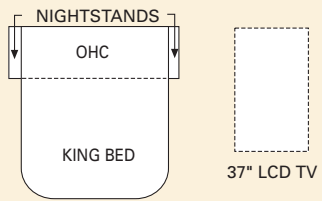

42' Emerald

42' Emerald Floorplan Options

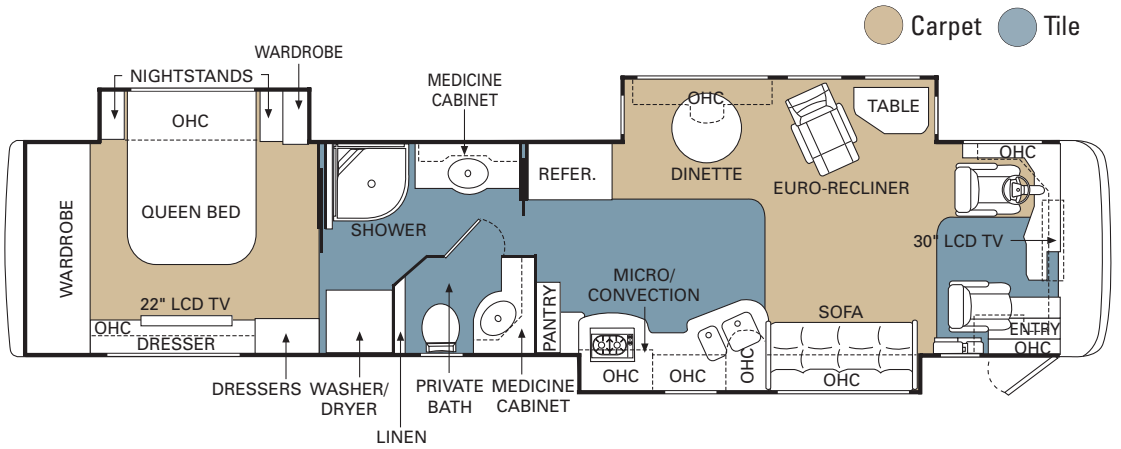
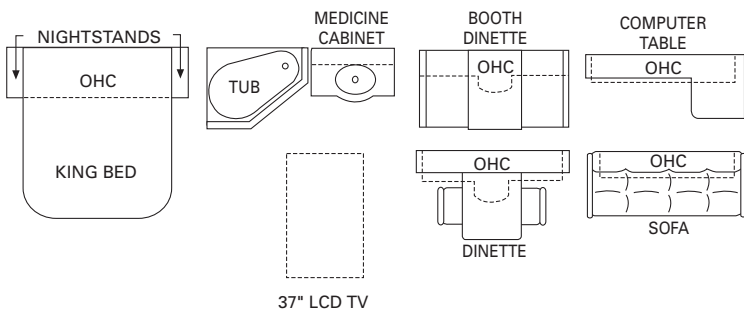

42' Garnet

42' Garnet Floorplan Options

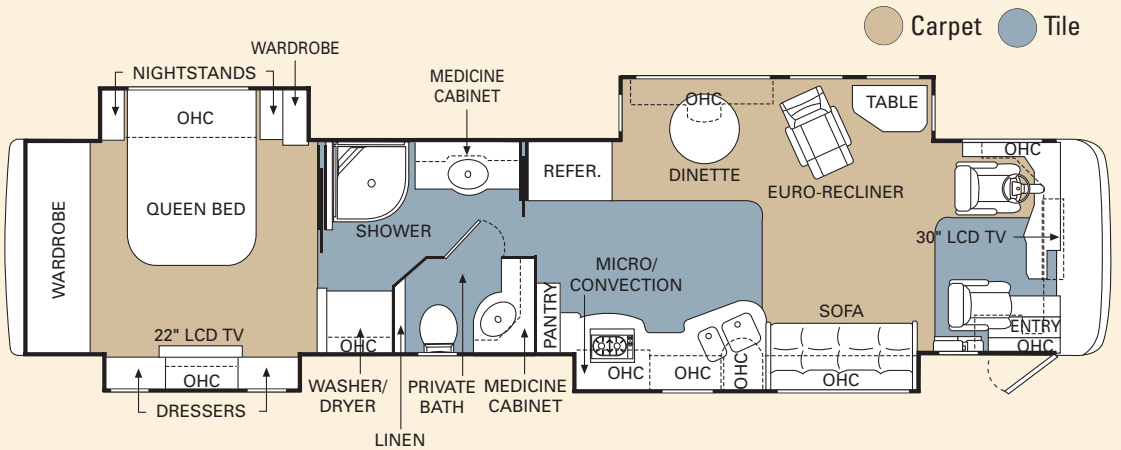
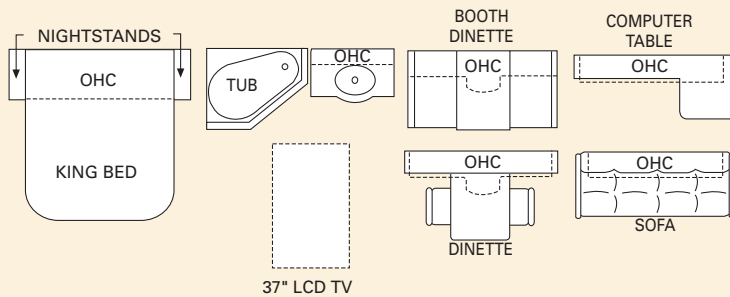

42' Topaz

42' Topaz Floorplan Options

2005 Marquis Floorplans and Options

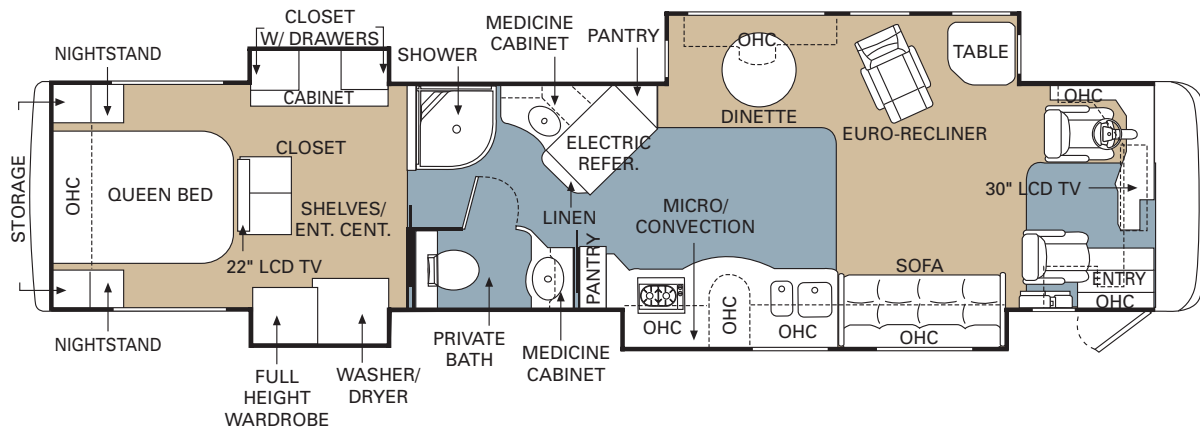
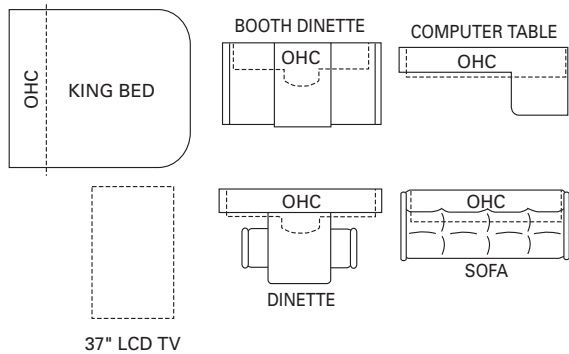

42' Opal Floorplan Options

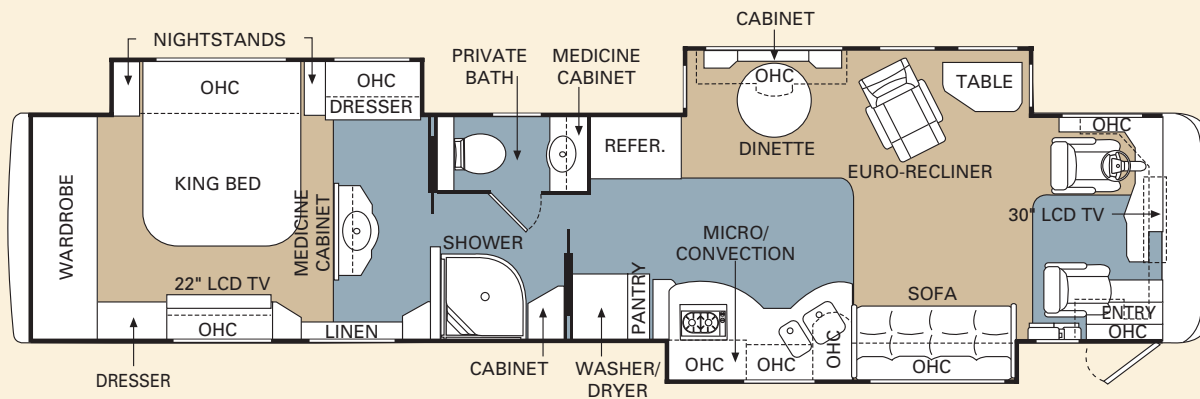
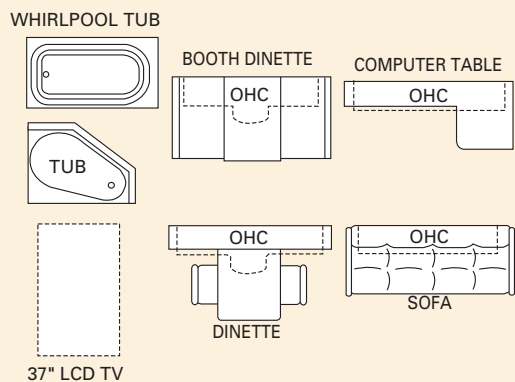

45' Sapphire Floorplan Options

42' Opal

45' Sapphire

2005 Marquis Floorplans and Options

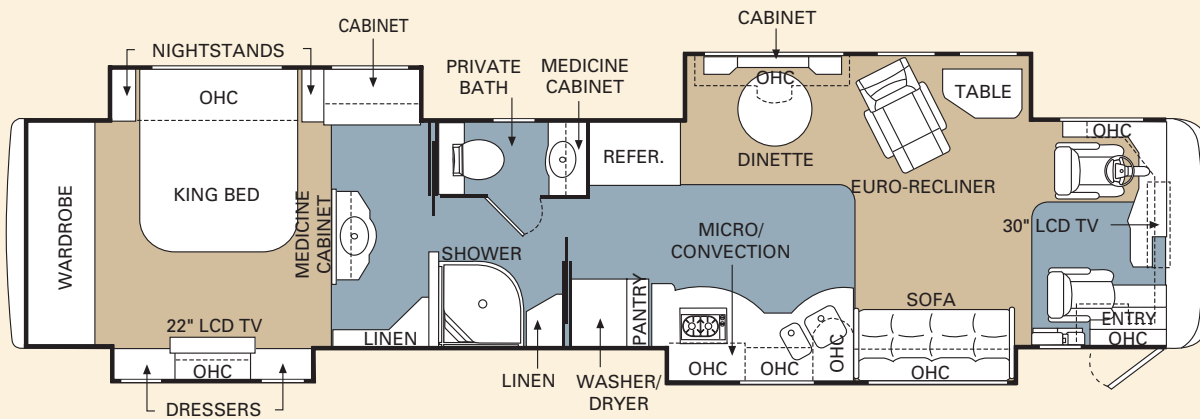
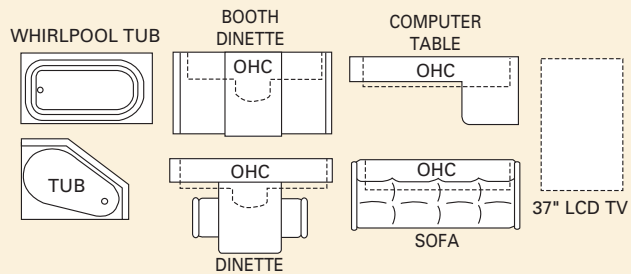

● Carpet ● Tile

45' Jade Floorplan Options

45' Jade

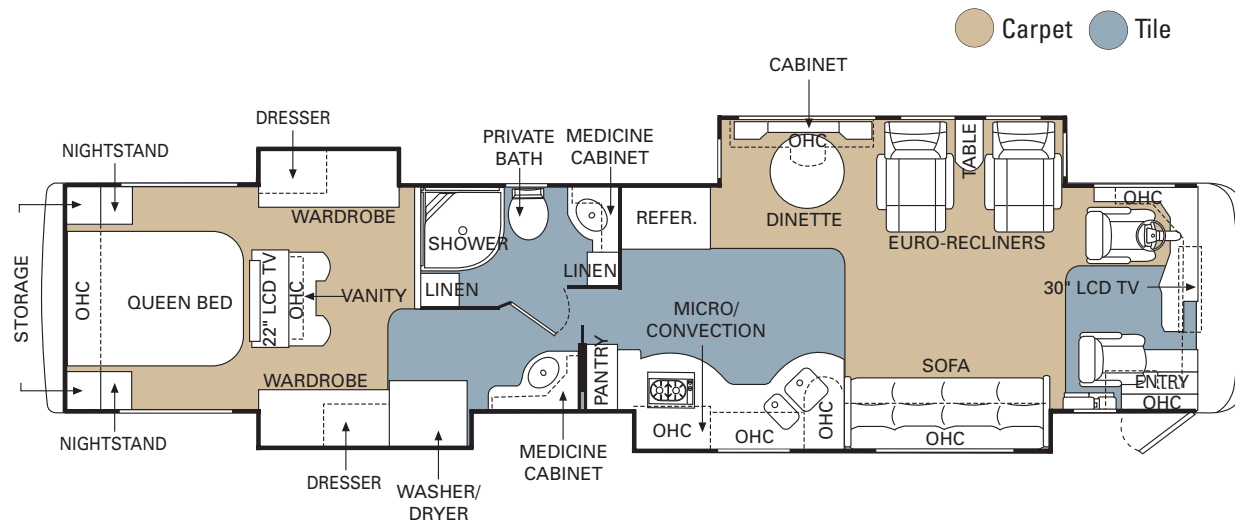
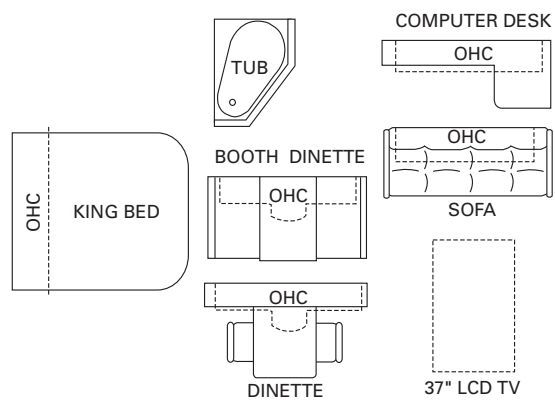

● Carpet ● Tile

45' Onyx Floorplan Options

45' Onyx

2005 Marquis Specifications

Body Construction

Standard Features

Aluminum Framed Superstructure
 Seamless One-Piece Molded Crowned Fiberglass Roof
 Laminated Gel Coat Fiberglass Sidewalls
 All Season Foam Insulated Roof
 One-Piece Front and Rear Molded Fiberglass Caps with Recess in Front Cap for Mirror Bases and Integrated Air and Turbo Intake in Rear Cap
 One-Piece Windshield
 Chrome Triple Head Power Controlled Heated Exterior Mirrors
 Aluminum Framed Laminated Floor on Steel Trusses
 Foam Insulated Underbelly
 Driving Lights
 Roof-Mounted Dual Trumpet Air Horns
 Insulated Aluminum Side-Hinged Baggage Doors under Passenger Side Front Slide-Out with Power Locks
 Stationary Storage Bays on Passenger Side
 Carpet-Lined Storage Compartments
 Full-Length "Beaver" Mud Flap
 Chrome Rocker Trim
 Rear Ladder
 Power Entry Step
 Entry Step Storage

Options

3M® Film Front Mask
 Exterior Sunscreens
 Electric Slide-Out Storage Tray (Complete Pass-Through)
 Additional Manual Storage Bay Slide-Out Storage Tray (One Side)
 Two Additional Manual Storage Bay Slide-Out Storage Trays (One Side) (N/A: 40' Ruby, 40' Pearl)

Chassis/Engine/Suspension

Standard Features

Roadmaster M10S-Series Chassis
 Caterpillar® 525HP C-13 and Allison® 4000 MH 6-Speed Transmission with Electronic Shifter; 1650 Lbs./Ft. Torque Max. Net. @ 1200 RPMs; 763"/12.0L Engine Displacement
 Rear Axle Ratio: 4.33:1
 160 Amp Alternator
 Dual Fuel Fill
 Polished Aluminum Wheels
 Tires: 295/80R/22.5
 Cushion Air Glide Suspension with Ten Air Bags and Ten Shock Absorbers
 Anti-Lock Braking System with Full Air Brakes (Disc)
 Anti-Lock Braking System on Tag Axle (Drum)
 Auto Slack Adjusters
 Automatic Traction Control
 Jacobs Engine Brake
 Fuel/Water Separator
 Air Cleaner Restriction Indicator
 Engine Block Heater with Switch on Dash
 Hydraulic Leveling System
 Engine Diagnostic Plug in Engine Area
 10,000 Lb. Hitch Receiver and 7/4 Trailer Plug
 Undercoating

Options

Dual Leveling System (Air/Hydraulic)
 Air Leveling

Cockpit

Standard Features

Fiberglass Automotive Dash with Roman Bronze Instrumentation Panel, Black Gauges with Gray Lettering and Gun Metal Bezels

Rear Vision Camera with Color Monitor
 In-Dash AM/FM Stereo with Multi-Disc CD Changer
 CB Radio
 Aladdin™ Video Coach Systems Monitor with SEE-Vision Security Cameras with Audible Alarm Tone
 Adjustable Accelerator and Brake Pedals
 Multiplug in Dash Area
 Intermittent Windshield Wipers
 Audible Turn Signals
 Two-Tone Leather VIP Lighted Smartwheel* with Controls for Windshield Wipers, ICC, and Cruise Control
 Power Steering
 6-Way Power OptimaLeather™ Pilot and Co-Pilot Seat with Lumbar and Adjustable Headrest on Both and Footrest on Passenger Seat
 Air Powered Front Entry Step Cover
 Carpeted Pilot and Co-Pilot Floor mats
 Power Sunvisors with Driver and Passenger Switch
 Power Privacy Cab Drapes
 Soft Cruise Electronic Cruise Control

Options

OptimaLeather™ Extra-Wide Co-Pilot Seat with Power Footrest
 Global Positioning System with Touchscreen Navigator Unit, 1 Map DVD
 OnStar® Mobile Assistance (Requires Subscription)
 Sirius Satellite Stereo (Requires Subscription)
 Cellular Antenna and Wiring

Appliances and Accessories

Standard Features

Four-Door Refrigerator with Ice Maker and Raised Panel Doors
 High-Output Two-Burner Recessed Cooktop
 Convection Microwave with Touch Control
 32" LCD TV with Remote in Living Area

22" LCD TV with Remote Control in Bedroom
 Power TV Antenna and Booster with 12V Recept and TV Jack(s)
 Universal Remote System
 Home Theater System: AM/FM Stereo, Acoustimass® Bass Module, Surround Speakers
 Basement Speakers
 VCR/DVD Combo Unit in Bedroom
 Fully Automatic Digital Satellite System with Receiver in Living Area and Bedroom
 Cable TV Hook-Up and Telephone Jacks
 Combination Washer/Dryer
 Door Bell

Options

37" LCD TV in Living Area Ceiling with Textured Vinyl Cover
 Residential Refrigerator
 Fully Automatic In-Motion Digital Satellite System with Receiver in Living Area and Bedroom
 Dishwashing Drawer
 Bose® 321 Entertainment System in Bedroom (Deletes VCR/DVD Combo)

Interior

Standard Features

High Gloss Euro-Finish with Exotic Wood Inlays
 Solid Wood Raised Panel Cabinet Doors with Hidden Hinges
 Carpet-Lined Cabinet Shelves
 Low-Friction Roller Drawer Guides
 Textured Vinyl Ceiling with Tiered Wood Design
 Vinyl Wallpaper with Chair Rail in Living Area
 High Gloss Solid Surface Galley Countertop with Integrated Solid Surface Sink
 High Gloss Solid Surface Bath Countertop with Solid Surface Edge and Integrated Sink
 Tile Galley Backsplash Design

Tile and Mirror Vanity Backsplash Design
Sculpted Glass Splash Guard at Edge of Galley
Large Pot and Pan Drawer in Kitchen Area
Appliance Garage on Kitchen Countertop
(N/A: 45' Sapphire, 45' Jade, 45' Onyx)
Cutting Boards in Kitchen
Built-In Storage Area for Kitchen Countertop Covers
Cedar-Lined Wardrobe Closet with Obscure Glass Wardrobe Doors
Medicine Cabinet
Bathroom Vanity Mirror
Decorative Hardwood Slide-Out Fascia Trim
Solid Mirror with Beveled Edges on Refrigerator Wall with Decorative Slide-Out Fascia Column Accent Frame
Bedroom Dresser
Bedspread with Pillows
Power Roman Shades with Pleated Shades in Living Area and Bedroom
Mini-Blinds in Kitchen and Bathroom
Corian® Window Sills in Living Area
Plush Carpet in Living Room and Bedroom
Sculptured Carpet Design in Living Area
Ceramic Tile in Entry, Kitchen and Bath Area

Options

Decors: Moulin Rouge, Copper Patina, Golden Amber, Zen
Paloma Picasso Decor: Birds of Paradise with Tile Aisle from Entry to Kitchen
Gloss Finish Cabinetry Choices: Cherry, Mahogany, Maple
Maple Burl Accent Cabinet Door Inserts with Cherry and Mahogany Cabinetry
Mappa Burl Accent Cabinet Door Inserts with Cherry and Maple Cabinetry
Makori Accent Cabinet Door Inserts with Cherry Cabinetry
Bird's-Eye Maple Accent Cabinet Door Inserts with Maple Cabinetry
Wine Glass Cabinet

Furniture

Standard Features

Queen Mattress
(N/A: 45' Sapphire, 45' Jade)
King Bed
(45' Sapphire, 45' Jade)
New Furniture Style
Sleeper Sofa with Drawer
OptimaLeather™ Euro-Recliner with Ottoman
Solid Surface Fixed Living Area Table
Dinette Table, Wood Round with 12" Leaf with Two Freestanding Dinette Chairs and Two Folding Chairs

Options

King Bed (N/A: 45' Sapphire and 45' Jade)
Queen Air Mattress with Remote
King Air Mattress with Remote
OptimaLeather™ Recliner
OptimaLeather™ Love Seat with Drawer
OptimaLeather™ L-Sofa with Drawer
OptimaLeather™ Sofa with Drawer
OptimaLeather™ Hide-a-Bed
Fabric Hide-a-Bed with Air Mattress
Air Mattress for a Hide-a-Bed
Wraparound Computer Table (Requires Recliner)
Side-Slide, Solid Surface Fixed Dining Table with Dinette Cabinet (N/A: 42' Amethyst, 42' Emerald)
Booth Dinette (N/A: 42' Amethyst, 42' Emerald)

Electrical Systems and Lights

Standard Features

50 Amp 120/240V Distribution Panel and Power Cord with Quick Disconnect
Locking Battery Disconnect Switch inside Coach
Battery Disconnect Switch in Battery Compartment

Onan® 12.5 kW Quiet Diesel Generator on Power Slide-Out Tray with Auxiliary Start Switch

Surge Protector
2,500 Watt Pure Sine Wave Inverter
Two Solar Panels with Regulator
Solar Connector
Two 12V Deep Cycle Chassis Batteries
Six 6V Deep Cycle Coach Batteries
Lights in Outside Storage Compartment
120V Receptacle in Storage Compartment
Recessed Stepwell Lights
Decorative Lighting in Bedroom and Living Area
Cosmetic Vanity Light
Halogen Lights in Living Area Ceiling
Halogen Lights under Overhead Cabinets
110V Receptacle in Private Lavatory
110V Receptacle in Bed Base
Computer Hook-Up with Phone Jack at Dinette Area
Docking Lights
Driving Lights
Pilot/Co-Pilot Reading Lights
Porch Light

Plumbing and LP Systems

Standard Features

Manifold Water Control System
One Touch Pullout Faucet
Insta-Hot® Water System in Kitchen
Water Pump Switches in Galley, Bath and Water Bay
Water Purifier in Ice Maker
China Toilet
Waste Master Drain System
Insulated Systems Compartment with Easy Access to Hook-Ups
Water Sprayer in Outside Bay
Power Water Hose Reel

Pressurized Water Fill
Soap Dispenser in Galley

Solid Surface Shower with Accent Corian® Inlay Design and Corian® Shower Caddy

Options

Whirlpool Tub (40' Ruby, 45' Sapphire, 45' Jade)
Garden Tub with Clear Surround
(N/A: 40' Pearl, 42' Amethyst, 42' Emerald)

Heating, Vents and Air Conditioning

Standard Features

Two Low-Profile Ducted 15 BTU Roof Air Conditioners with Heat Pumps
Three Low-Profile Ducted 15 BTU Roof Air Conditioners with Heat Pumps
Aqua-Hot® Hydronic System
Electronic AC/Heat Climate Control System
Dash Heating and Air Conditioner System with Defroster
12V Attic Fan with Sensor and Wall Switch in Kitchen, Bath and Vanity Area

Options

Two Low-Profile 110v Baseboard Heaters

Windows, Doors and Awnings

Standard Features

Radius Dual Pane Safety Glass Dark Tinted Slider Windows
Front Entry Door with Removable Screen
Keyless Entry System with Pocket Remote
Tinted Skylight in Bathroom
Girard® Automatic Patio Awning with Wind Sensor
Slide-Out Topper Awnings
Window Awnings with Color-Coordinated Hardware
Automatic Front Door Awning

Safety

Standard Features

- Fire Extinguisher
- Back-Up Alarm
- Deadbolt Lock on Entrance Door
- Lighted Interior and Exterior Grab Handles
- 120V GFI Protected Circuit
- LP Gas Detector
- Smoke Detector
- Carbon Monoxide Detector
- Integrated Pilot and Co-Pilot Three-Point Seat Belts
- Third Brake Safety Light
- Egress Window(s)
- Safe

Options

- Deluxe Security System
- Collision Avoidance System

Weights

Gross Vehicle Weight Rating (Lbs.)

40' Ruby	46,300
40' Pearl	46,300
42' Amethyst	46,300
42' Emerald	46,300
42' Garnet	46,300
42' Topaz	46,300
42' Opal	46,300
45' Sapphire	46,300
45' Jade	46,300
45' Onyx	46,300

Gross Combined Weight Rating* (Lbs.)

40' Ruby	56,300
40' Pearl	56,300
42' Amethyst	56,300
42' Emerald	56,300
42' Garnet	56,300
42' Topaz	56,300
42' Opal	56,300
45' Sapphire	56,300
45' Jade	56,300
45' Onyx	56,300

Front Gross Axle Weight Rating (Lbs.)

40' Ruby	15,300
40' Pearl	15,300
42' Amethyst	15,300
42' Emerald	15,300
42' Garnet	15,300
42' Topaz	15,300
42' Opal	15,300
45' Sapphire	15,300
45' Jade	15,300
45' Onyx	15,300

Rear Gross Axle Weight Rating

40' Ruby	21,000
40' Pearl	21,000
42' Amethyst	21,000
42' Emerald	21,000
42' Garnet	21,000
42' Topaz	21,000
42' Opal	21,000
45' Sapphire	21,000
45' Jade	21,000
45' Onyx	21,000

Tag Gross Axle Weight Rating (Lbs.)

40' Ruby	10,000
40' Pearl	10,000
42' Amethyst	10,000
42' Emerald	10,000
42' Garnet	10,000
42' Topaz	10,000
42' Opal	10,000
45' Sapphire	10,000
45' Jade	10,000
45' Onyx	10,000

Measurements

Wheelbase

40' Ruby	263-11/16"
40' Pearl	263-11/16"
42' Amethyst	286-11/16"
42' Emerald	286-11/16"
42' Garnet	286-11/16"
42' Topaz	286-11/16"
42' Opal	286-11/16"
45' Sapphire	310-11/16"
45' Jade	310-11/16"
45' Onyx	310-11/16"

Overall Unit (Length) (Width) (Height)

40' Ruby	40' 10"	102"	12' 6"
40' Pearl	40' 10"	102"	12' 6"
42' Amethyst	42' 10"	102"	12' 6"
42' Emerald	42' 10"	102"	12' 6"
42' Garnet	42' 10"	102"	12' 6"
42' Topaz	42' 10"	102"	12' 6"
42' Opal	42' 10"	102"	12' 6"
45' Sapphire	44' 10"	102"	12' 6"
45' Jade	44' 10"	102"	12' 6"
45' Onyx	44' 10"	102"	12' 6"

Interior Height

All Marquis Models	81"
--------------------	-----

Tank Capacities

Gray Tank

All Marquis Models	58 gal.
--------------------	---------

Black Tank

All Marquis Models	58 gal.
--------------------	---------

Fresh Tank

All Marquis Models	100 gal.
--------------------	----------

Fuel Tank

All Marquis Models	148 gal.
--------------------	----------

LP Tank**

All Marquis Models	29 gal.
--------------------	---------

* Towing capacity is limited by GCWR; your vehicle's towing capacity is the difference between the GCWR and the actual vehicle weight, including all water, fuel, passengers and cargo. Your towed vehicle should be equipped with auxiliary brakes if the weight of the towed vehicle exceeds 1,000 lbs. Consult your Owner's Manual for further towing information.

** Actual filled LP capacity is 80% of listing due to safety shut off required on tank.

All tank capacities are estimated based upon calculations provided by the tank manufacturers and represent approximate

capacities. The actual "usable capacity" may be greater or less than the estimated capacities based upon fabrication and installation of the tanks.

Due to the large variety of options and floorplan arrangements available to our customers, actual weights for each unit may differ. Beaver Motor Coaches provides a weight sticker on each unit we produce, which includes that unit's tank capacities and approximate weight. Consult your local Beaver Motor Coaches dealer for unit availability and further information. The information printed in this brochure reflects product design,

fabrication, and component parts at the date of printing. The manufacturer reserves the right, at any time, to make changes in product design, material or component specifications as its sole option, without notice. This includes the substitution of components of a different brand or trade name, which will result in comparable performance. All information printed in this brochure is subject to change after the date of printing. Some features shown or mentioned in this brochure are optional and may only be available in selected floorplans. Photographs may show props or decorations that are not standard equipment on

Beaver Motor Coach models. Beaver Motor Coaches, the Beaver logo and its design, are registered trademarks. All other products and company names are trademarks and/or registered trademarks of their respective holders.

The actual overall length of the recreational vehicle may differ from that indicated in the brochure due to variances in the manufacturing process and/or installed components. The actual length may be greater or less than that indicated.